

scott simons architects
designed for human potential



Rice Public Library

March 20, 2019

Meeting Agenda: Meeting No. 04 – Schematic Design Kick Off

Date: March 20, 2019
Project: Rice Public Library Renovation and Expansion
Location: Kittery, Maine
To: Kendra Amaral + Library Planning Committee
Prepared by: Scott Simons Scott Simons Architects
 Ryan Kanteres Scott Simons Architects
 Chris Berry Scott Simons Architects

Meeting title: Building Committee Meeting No 4

1. **Communications and Previous Business Items**
 - A. Accept previous Meeting Minutes

2. **Programming Study Presentation**
 - A. Review of Program Interviews
 1. Discuss apparent needs and recurring themes
 - B. Space Program
 1. Analysis of previous program
 2. Review of current recommendations
 - C. Building Assessments
 1. Discuss deferred maintenance requirements
 2. Summary of Final Report
 - D. Sustainability Goals
 1. Discuss goals of Energy Retrofit and New Construction

3. **Schematic Design Kick Off**
 - A. The Modern Library
 1. Community role
 2. Lessons learned from recent project work
 - B. Survey of Project Precedents
 1. Discussion of Material and Contextual Response
 - C. Preliminary Concept Designs
 1. Presentation of options
 2. Discussion of comparative merits
 - D. Committee Review
 1. Further discussion of goals
 2. Establishment of next steps

4. **New Business**

5. **Next meeting time** **TBD**

Rice Public Library:

Program Summary

As part of our programming effort, we met with Library staff, Friends of the Library and Board of Directors, teens, resource members of Traip Academy and Shapleigh Middle School, business leaders from the Foreside, and members of the Kittery Community Center.

Following is a summary of what we heard:

Primary program needs:

- Accessibility; add elevator
- Adequate space for children's programming, including weekly Story time. Also a craft area with a sink.
- Separate teen area with space for programming, gaming, etc.
- Meeting rooms for study, for small meetings, for tutoring, etc.
- Quiet reading area
- More space for DVD collection
- More display space, for books, for art
- Improved heating and cooling
- Flexible floor plan; multi-purpose spaces
- More light; more windows
- Welcoming entry area that includes room for 2 or 3 to gather
- Improved flow of materials: handling, sorting, and re-shelving
- More storage overall
- Parking: maintain adequate parking for staff and patrons
- Figure out what to do with leased spaces
- Accessible service entry
- More toilets (ADA)
- Office space for the director; more private work areas for staff



Some program additions it would be nice to have:

- Maker space
- Business center to support the many telecommuters in the area
- Café or place for at least be able to have a coffee
- Storage area for strollers during storytime

What to maintain:

- Welcoming and helpful staff
- Second floor reading room
- The Maine Room
- The charm of the existing library – keep the wood, the main staircase

	Lassel Program	SSA Program
Lobby	302	480
Public Meeting Room	1510	660
2 Study Rooms	240	240
Popular Library Collection	1088	1088
General Collection and Seating	2205	2205
Periodicals	419	300
Reference Collection and Seating	630	240
Local History/ Genealogy Room	428	428
e-Commons	360	120
Reference Services Desk	206	150
Reference Workroom/ Office	195	100
Storytime	930	960
Support / Maker / Craft Room	350	200
Quiet Reading Room	440	360
Computer Area	220	160
Children's Collection Area	1105	1105
Young Adults	725	725
Parenting Area	196	140
Children's Services Workroom	315	240
Children's Reference Desk	260	260
Galley Kitchen Alcove	40	/
Acquisitions, Cataloging, Processing Area	340	300
Storage Room	120	100
Director's Office	155	140
Workroom	191	200
Computer Server Room	80	80
Staff Lounge/ Lunch Room	183	160
Supplies Storage	200	120
Custodian	289	120
Galley Kitchen	40	/
Circulation Desk	490	360
Copier Alcove	150	/
Circulation Office	276	180
Fire and Vandal Proof Bookdrop Room	100	35
Small meeting room	/	180
Storage and Sorting Area	180	180
Toilet rooms	/	300
Egress stair	/	200
Total Net SF	14,958 SF	12,816 SF
Gross Factor	30%	20%
Total Gross SF	19,445 SF	15,379 SF

LASSEL PROPOSAL SSA PROPOSAL

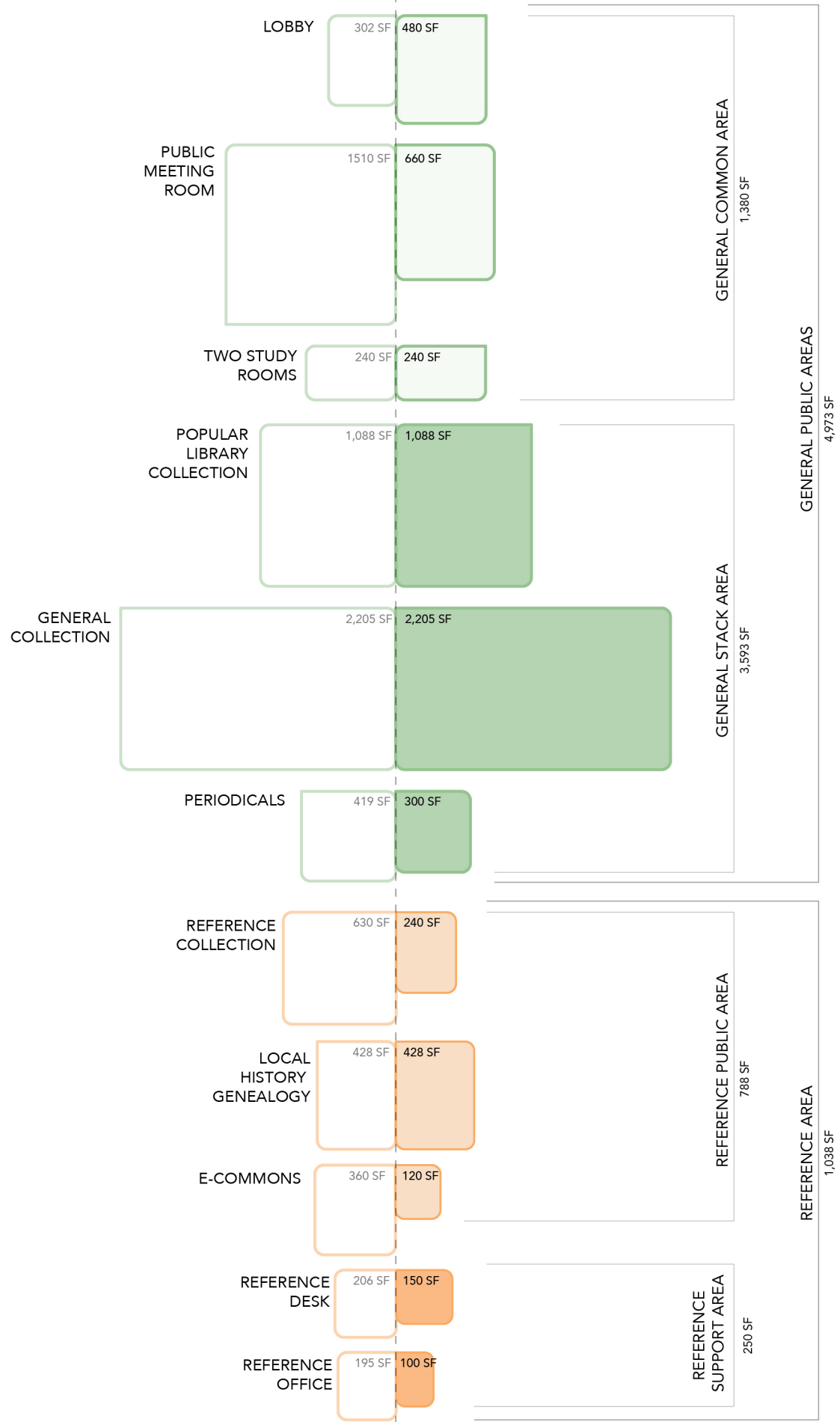

LASSEL PROPOSAL SSA PROPOSAL

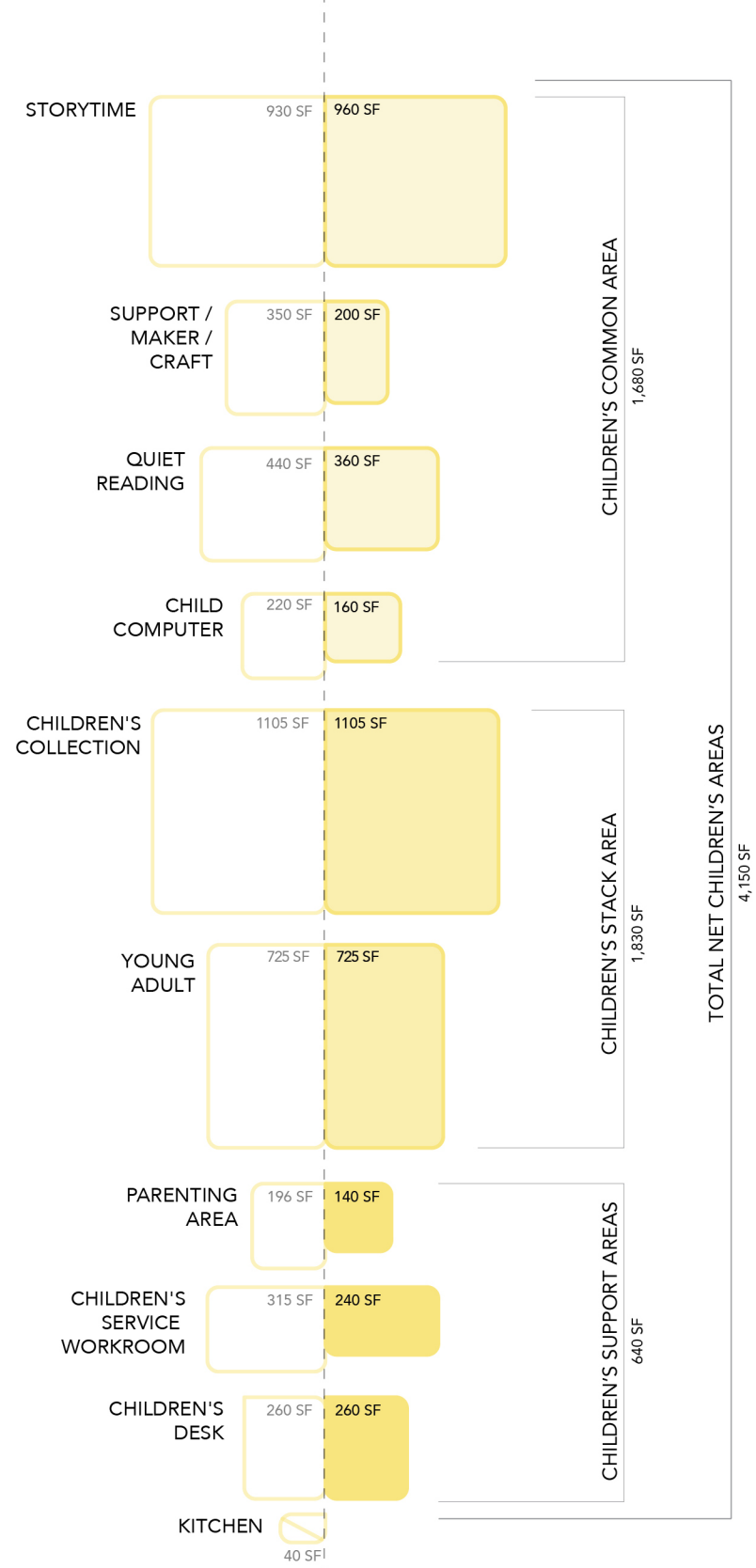

LASSEL PROPOSAL SSA PROPOSAL

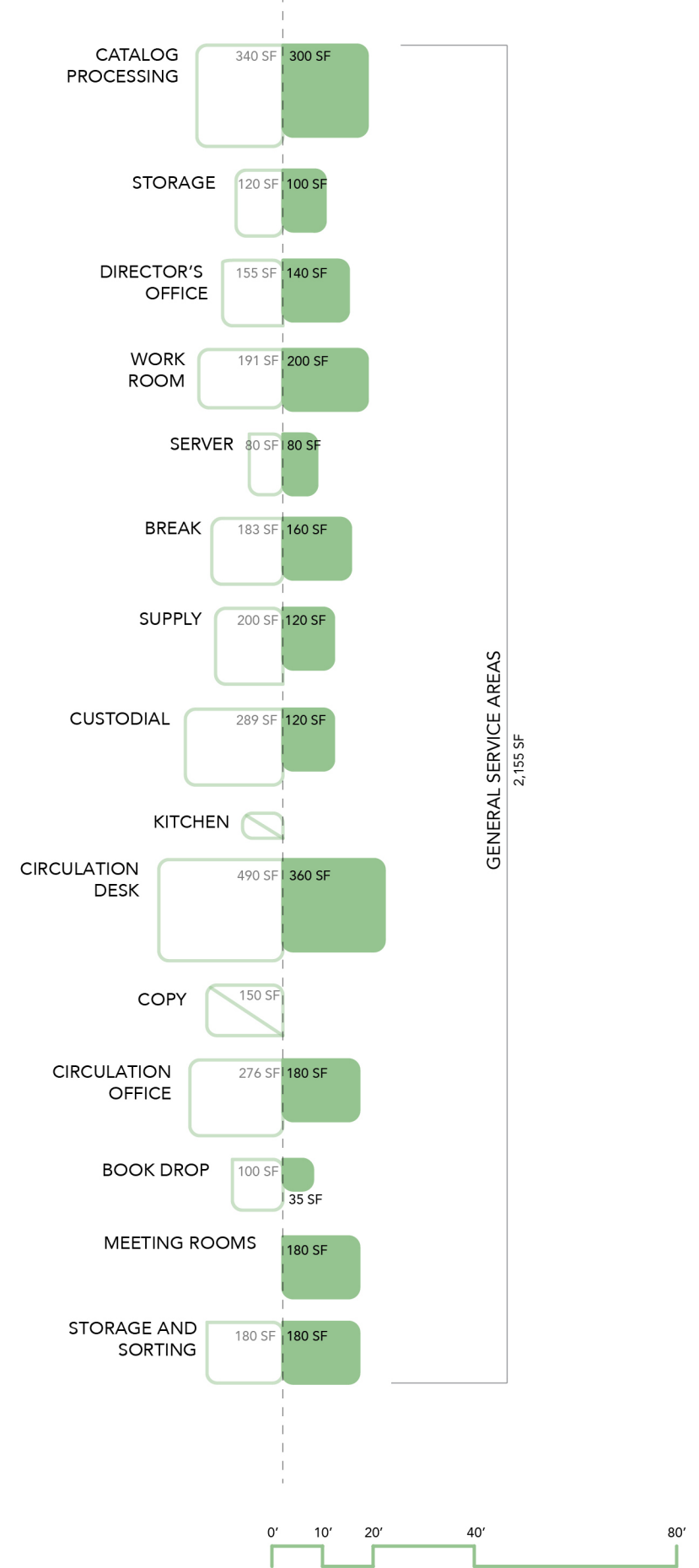

LIBRARY COLLECTION

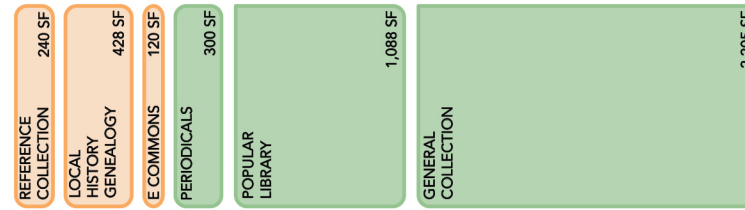

38,838 (46,606) General Collection Volumes
 2,200 (2,642) Audio
 3,900 (4,680) Video
 (collection volume + 20% growth factor)

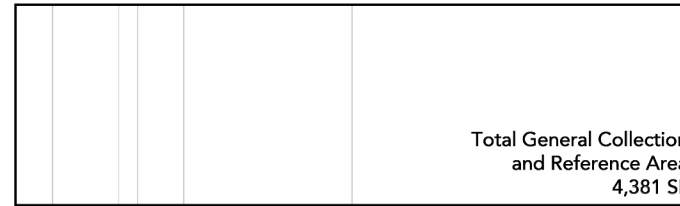

CHILDREN'S COLLECTION



19,624 (23,549) Children's / YA Volumes
 1,100 (1,320) Audio
 1,300 (1,560) Video

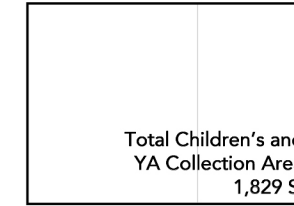

STACK DIAGRAM I - Mixed low and high Shelving

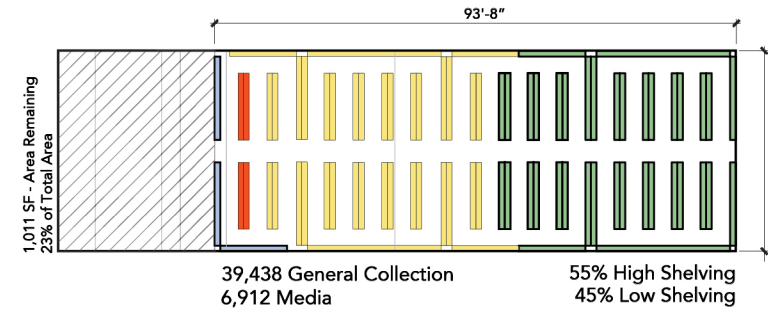

STACK DIAGRAM III - Mixed low and high Shelving

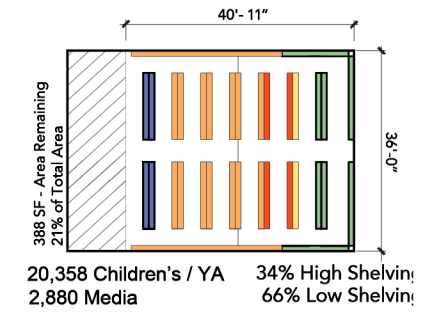

STACK DIAGRAM II - All Low Shelving

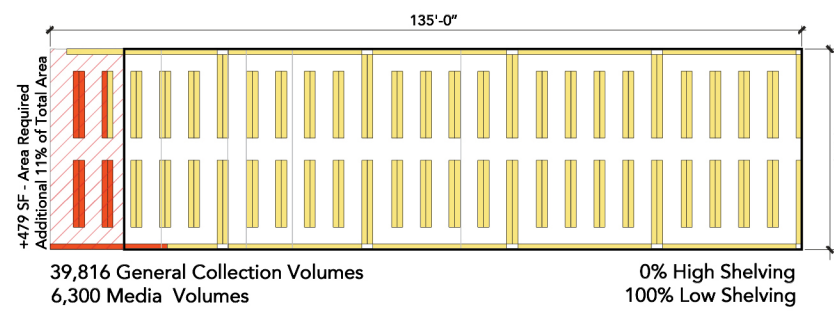

STACK DIAGRAM IV - Mostly Low Shelving

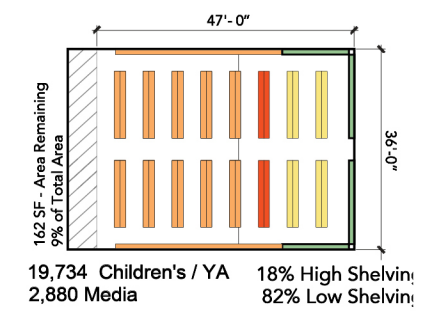

BOOK SHELVING

- 4 Shelves High
7 Volumes / Linear Foot
- 4 Shelves High
12 Volumes / Linear Foot

- 7 Shelves High
7 Volumes / Linear Foot
- 7 Shelves High
12 Volumes / Linear Foot

MEDIA SHELVING

- 5 Shelves High
12 Media / Linear Foot
- 8 Shelves High
12 Media / Linear Foot



LASSEL PROPOSAL | SSA PROPOSAL

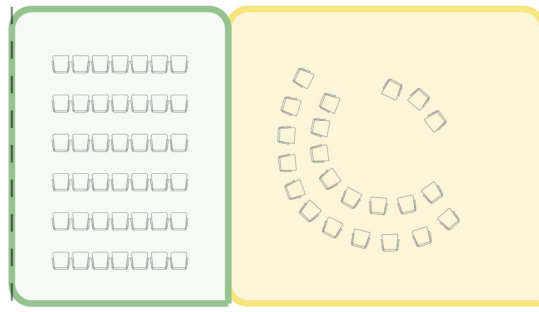
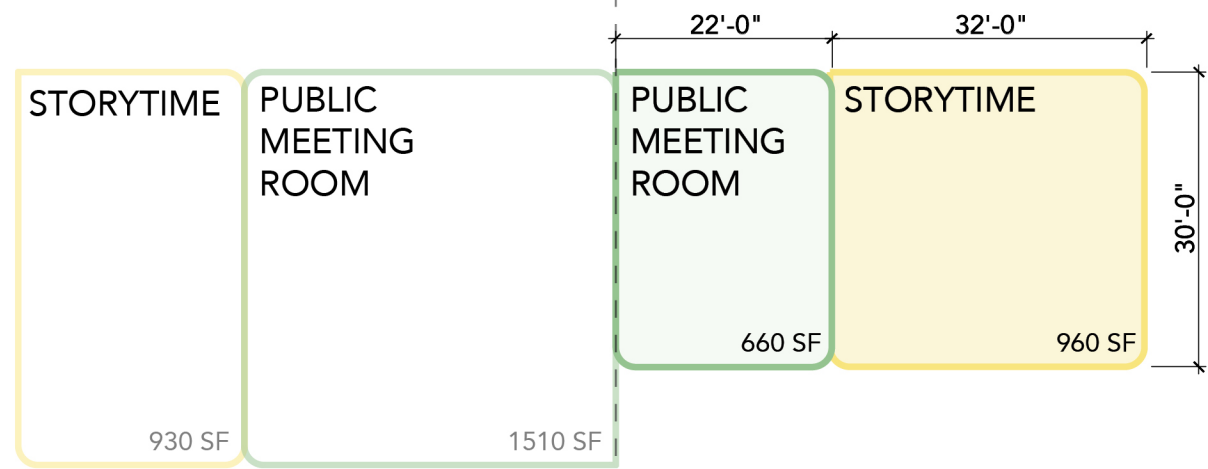

42 SEATS

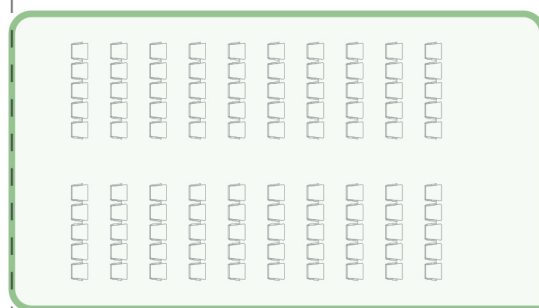

100 SEATS

1,620 SF

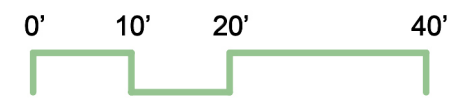

LASSEL PROPOSAL | SSA PROPOSAL

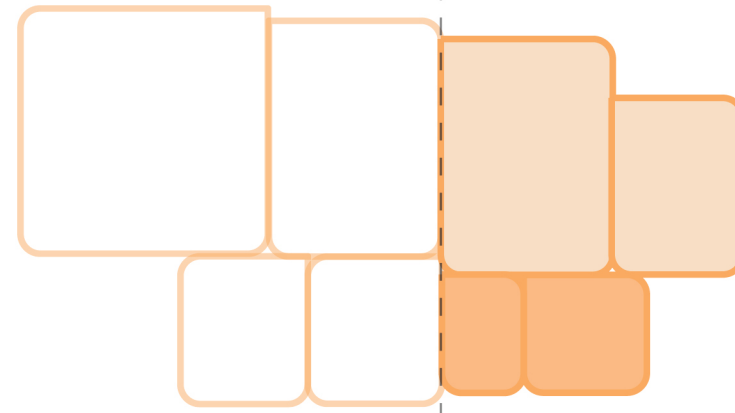

REFERENCE
COLLECTION

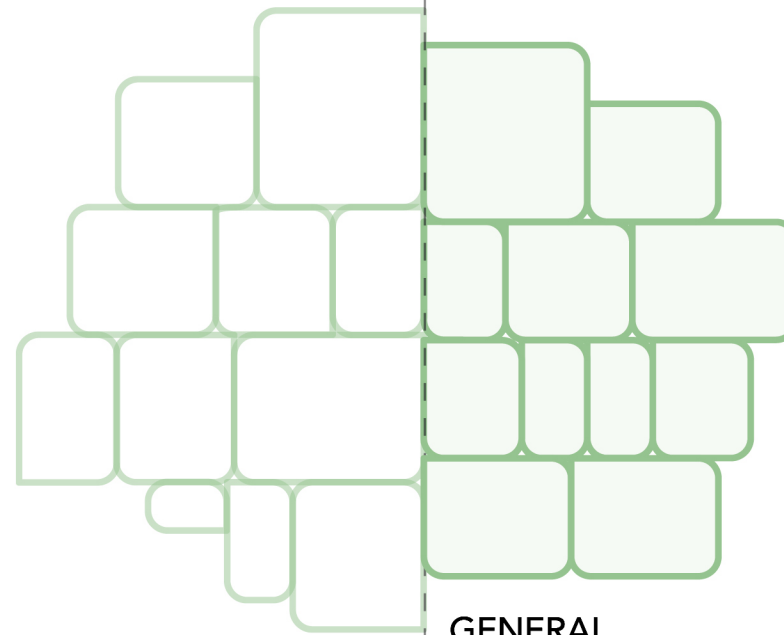



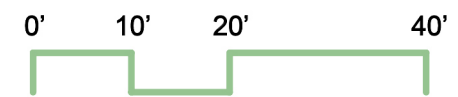
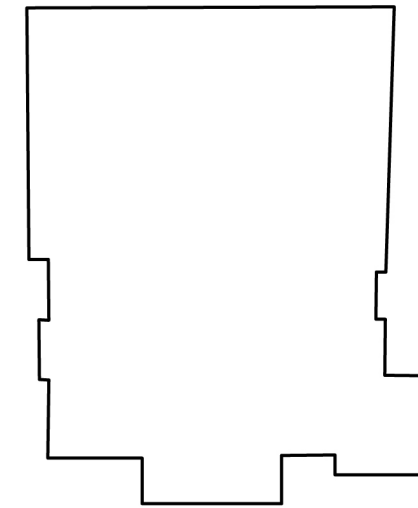
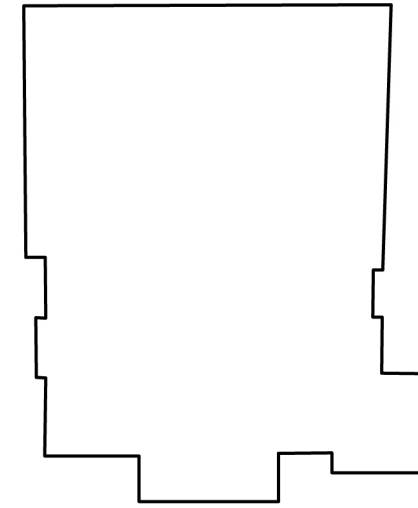



GENERAL
SERVICE
AREAS





Existing Building Assessments

	Green Building Target/ Certification	Description	\$ Increase
	Living Building Challenge	Most aggressive and challenging green building system on the market. Only 5 fully certified living buildings, but hundreds, if not a thousand projects are in the pipeline. Requires 1 year of operation before certification. Requires net zero energy, net zero water, red list of materials and stringent use of local materials.	10-20%
	Living Building Challenge (Petal Certification)	Requires meeting at least one of the following petals/ categories: Energy, Water, Materials	5-10%
	Passive House Certification	Very hot industry topic right now. Strict (pass/fail energy requirements that result in about 80% reduced energy use. Unity has build a Passive house Dorm. Several single family homes in ME have been built. 2 major multifamily project are in the words and Friends School is under construction	5%
	Net Zero Energy	Similar to Botanical Gardens. Requires all electric systems and additional large PV array.	5% (assuming PPA for PV)
	Carbon Neutral	Allows for alternative fuel sources, purchase some offsets and some onsite PV	3-5%
	LEED Platinum v4	New LEED rating system is now available. Much more stringent on materials	2-5%





Portland Public Library



Seinajoki City Library, Finland



Allston Public Library

Machado Silveti



Cambridge Public Library

William Rawn Associates



NYPL Staten Island

Andrew Berman Architect

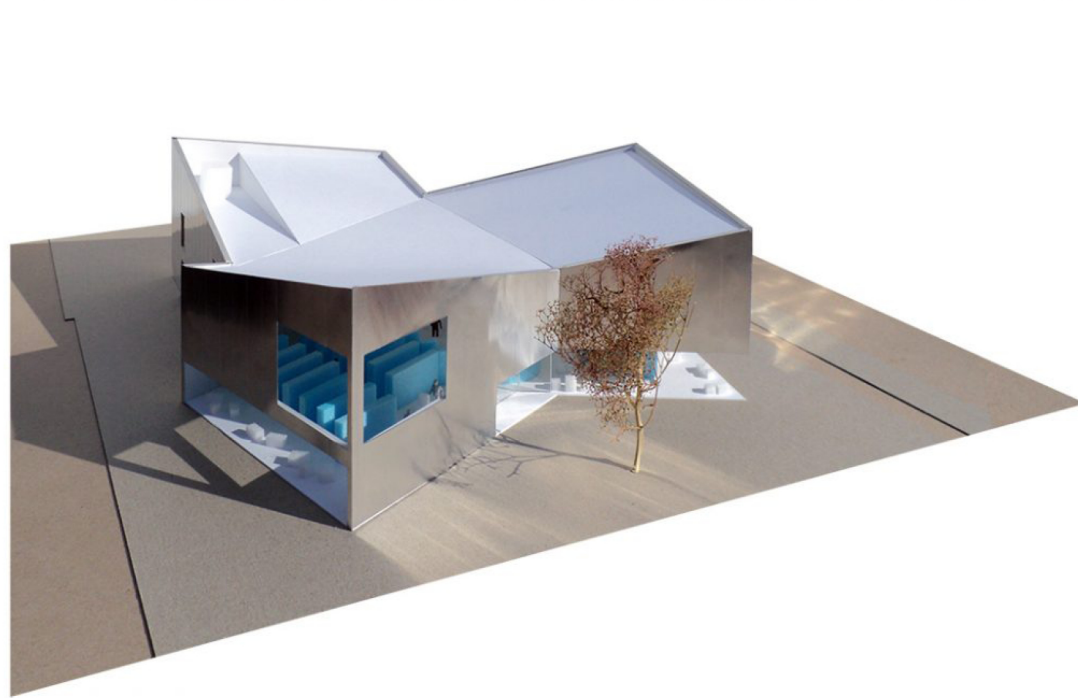
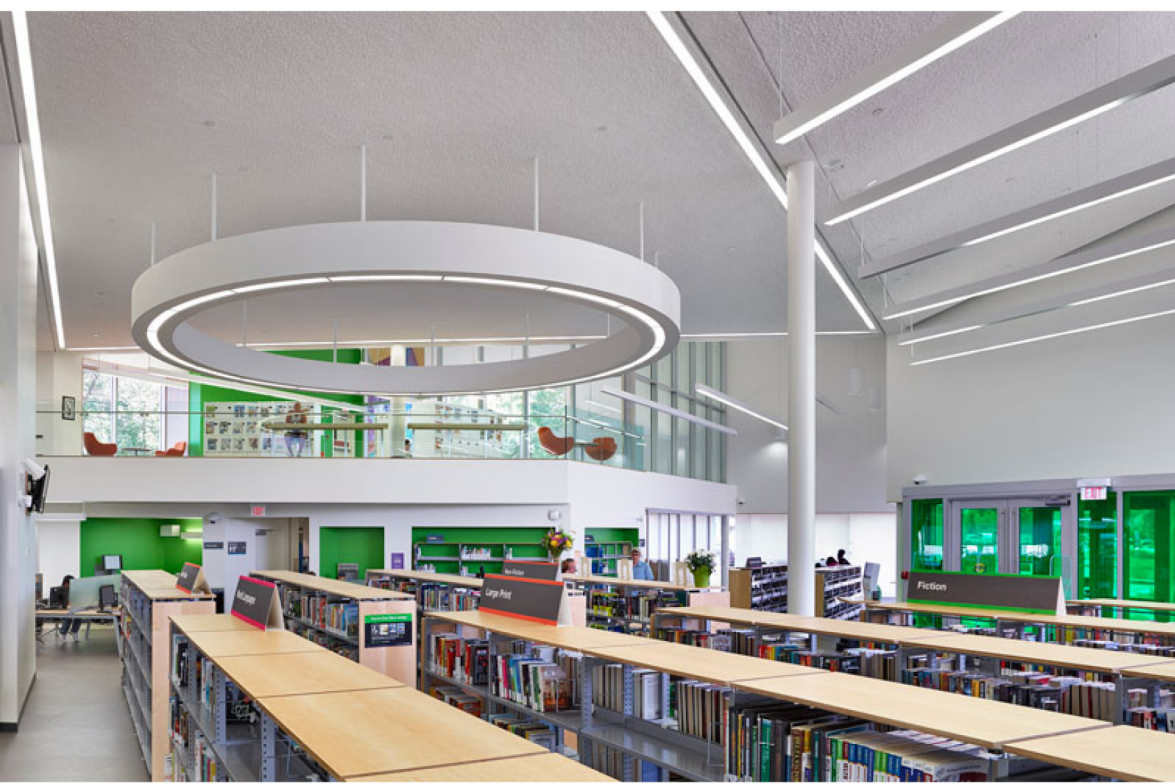
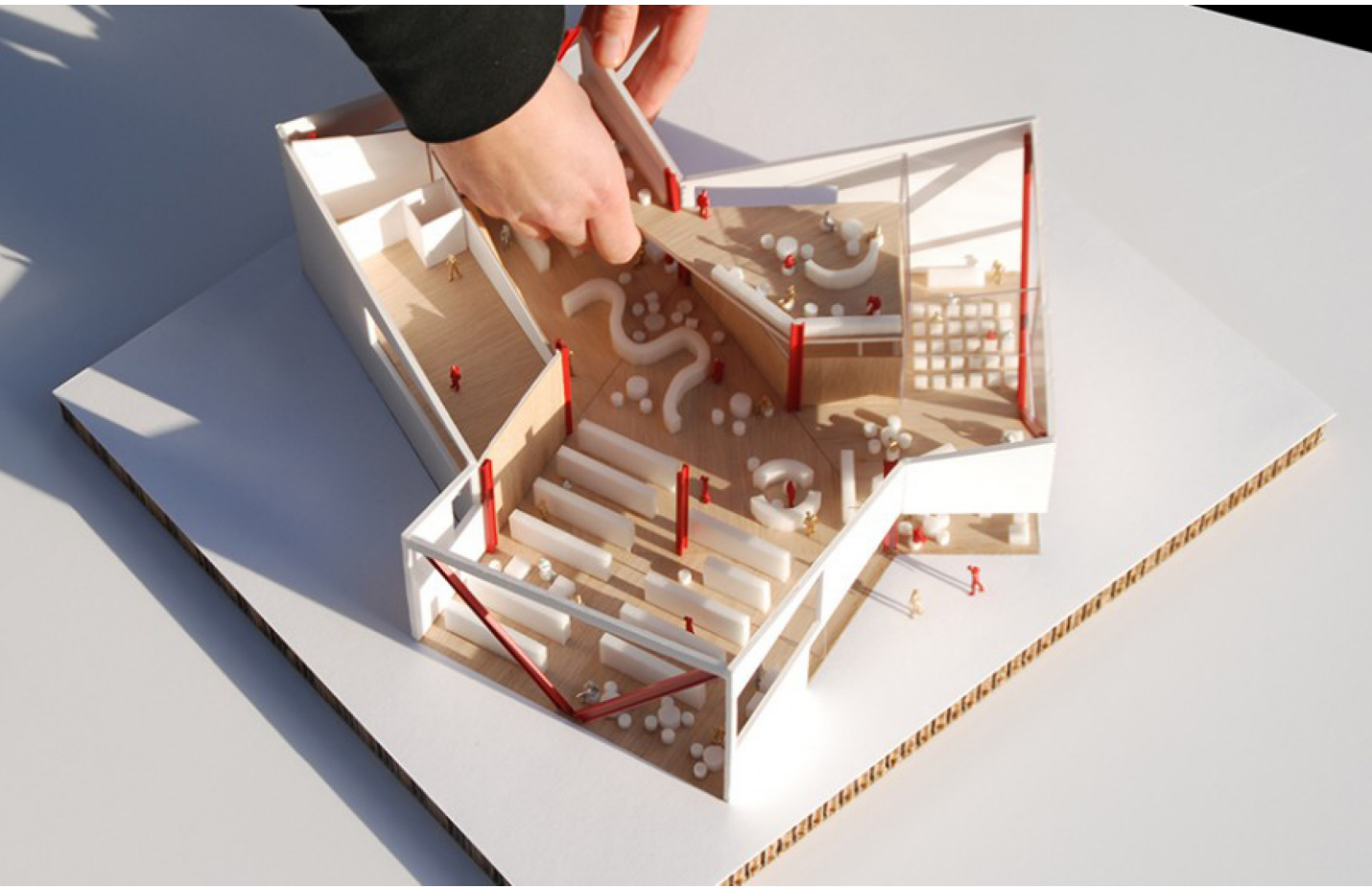

Edmonton Public Library, Highlands Branch

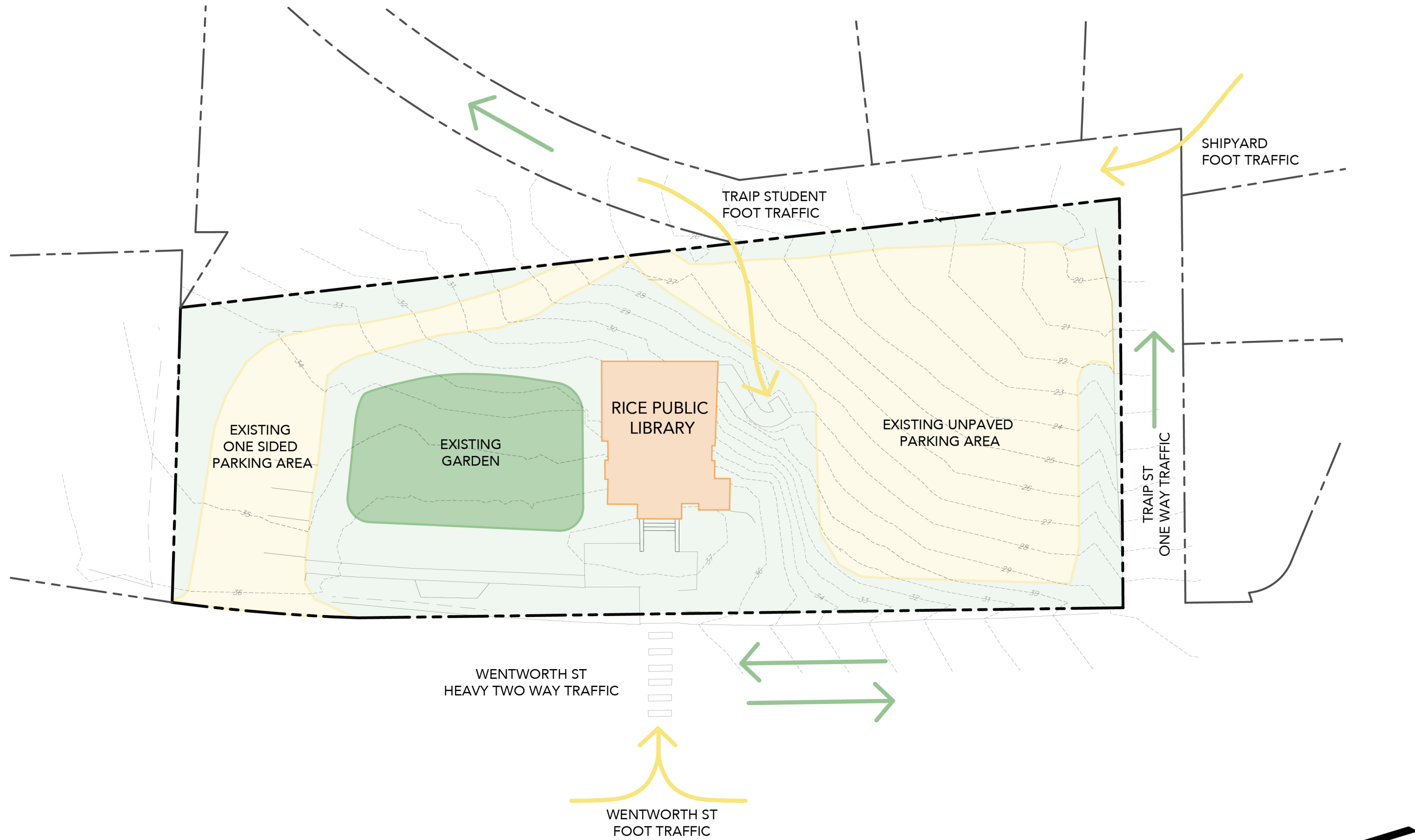

Existing Site Conditions

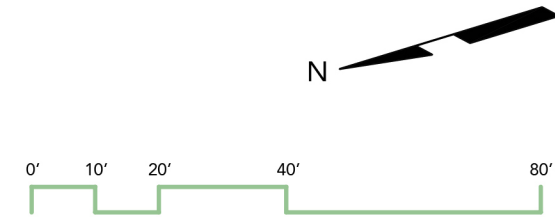

Scheme A

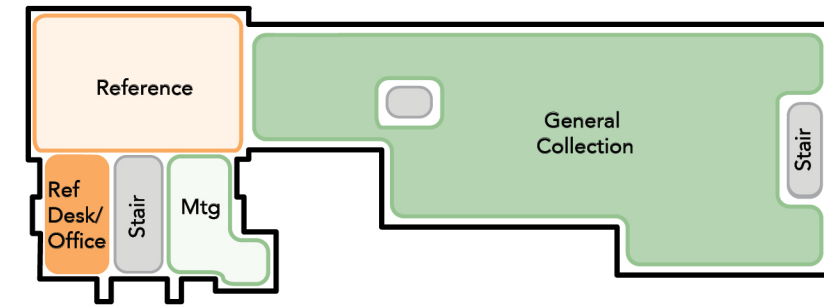

SECOND FLOOR PLAN

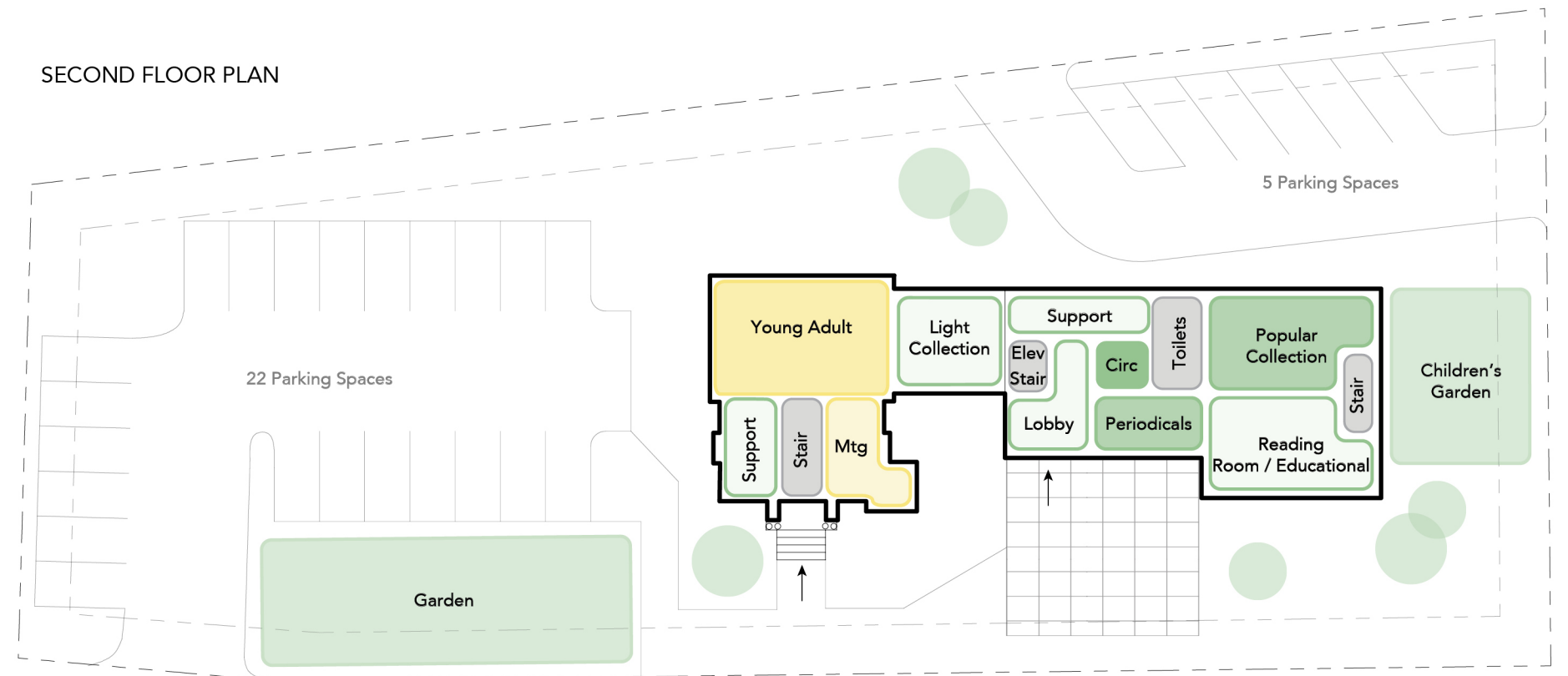

FIRST FLOOR PLAN

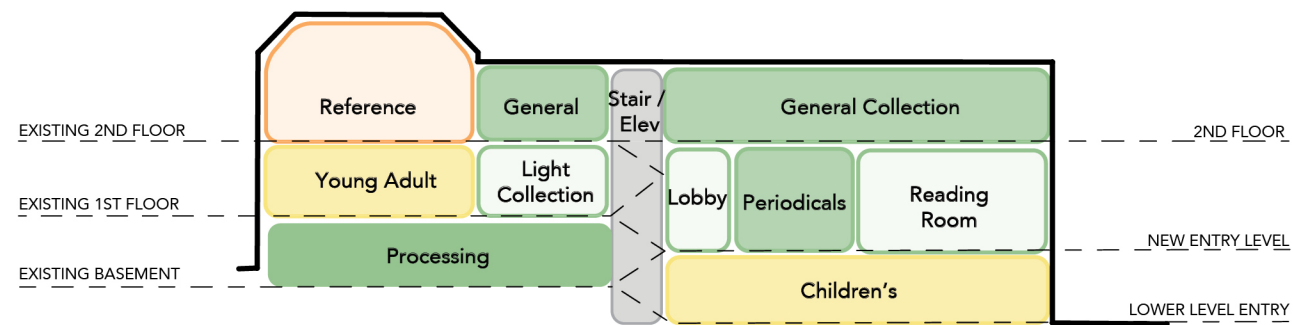

DIAGRAMMATIC BUILDING SECTION

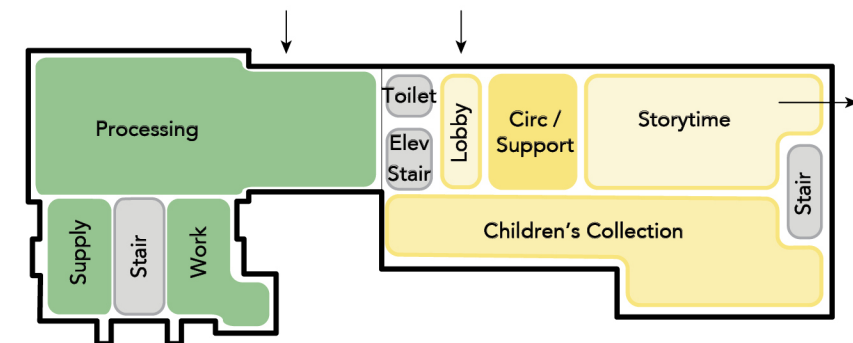

LOWER LEVEL FLOOR PLAN



Scheme B

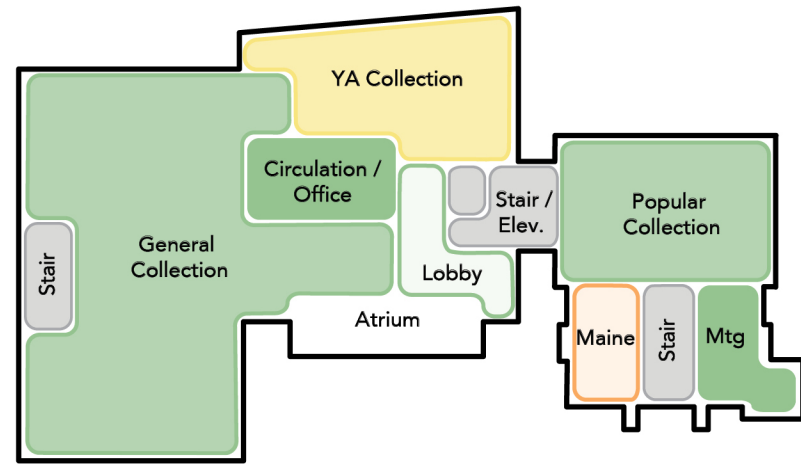

SECOND FLOOR PLAN

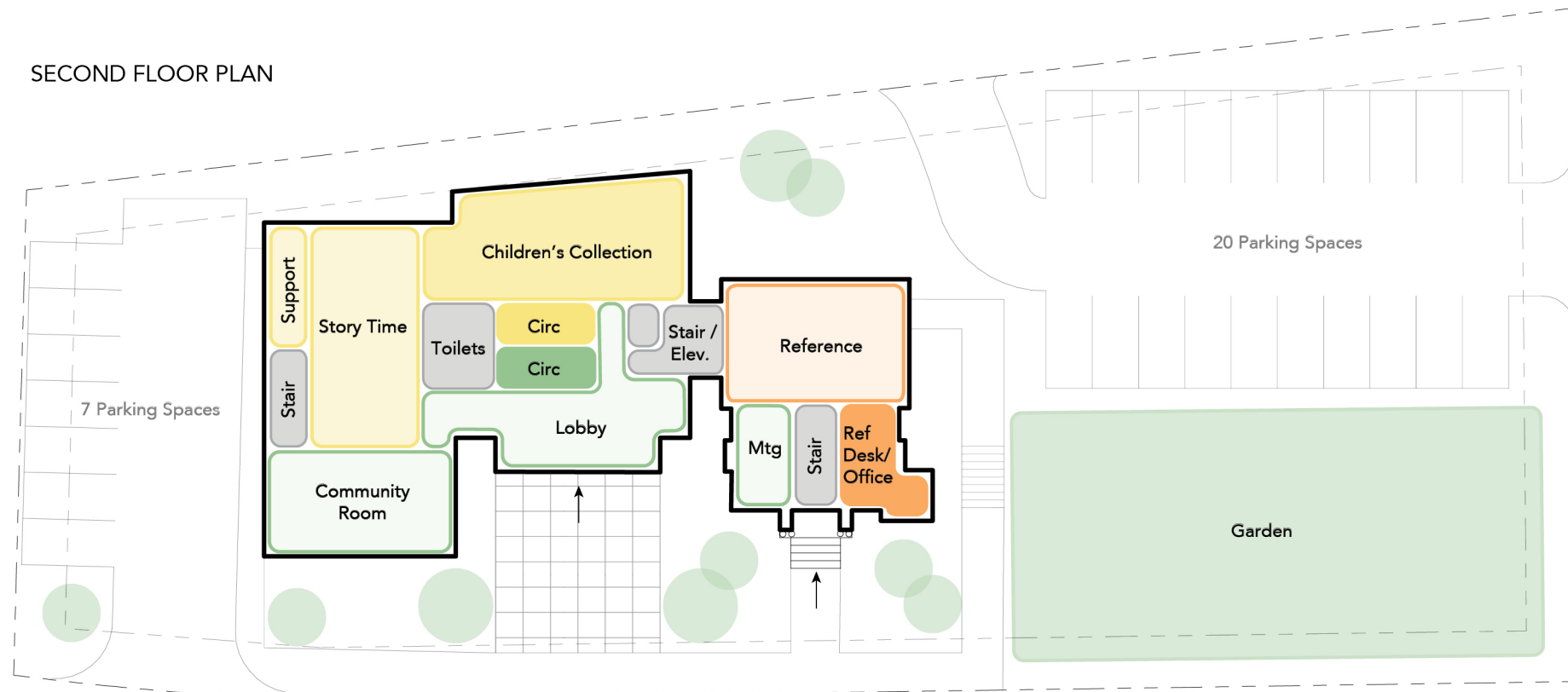

FIRST FLOOR PLAN

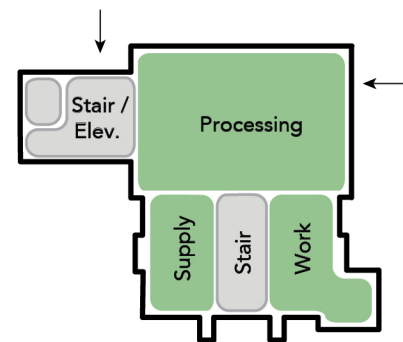

LOWER LEVEL FLOOR PLAN

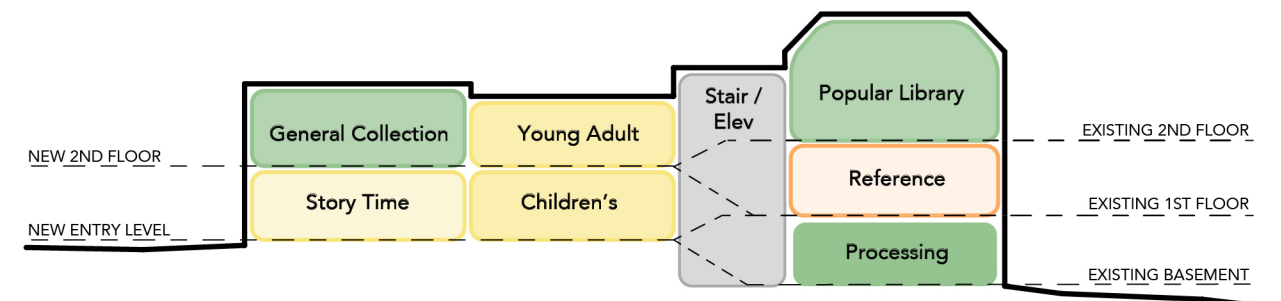

DIAGRAMMATIC BUILDING SECTION



Scheme C

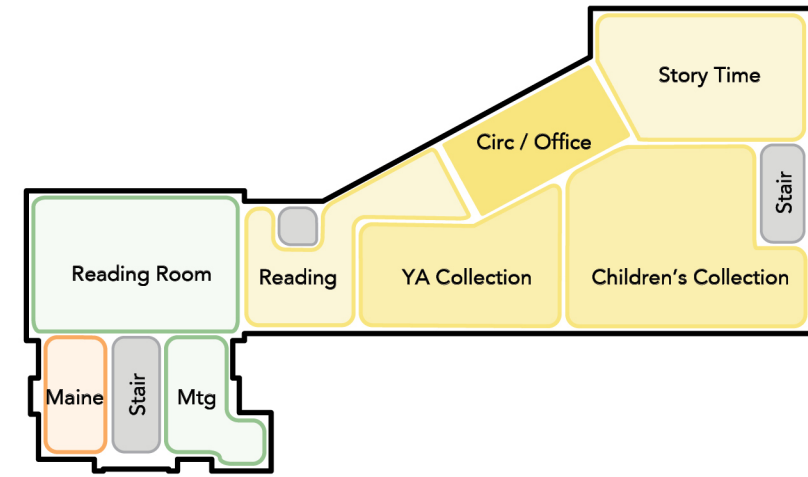

SECOND FLOOR PLAN

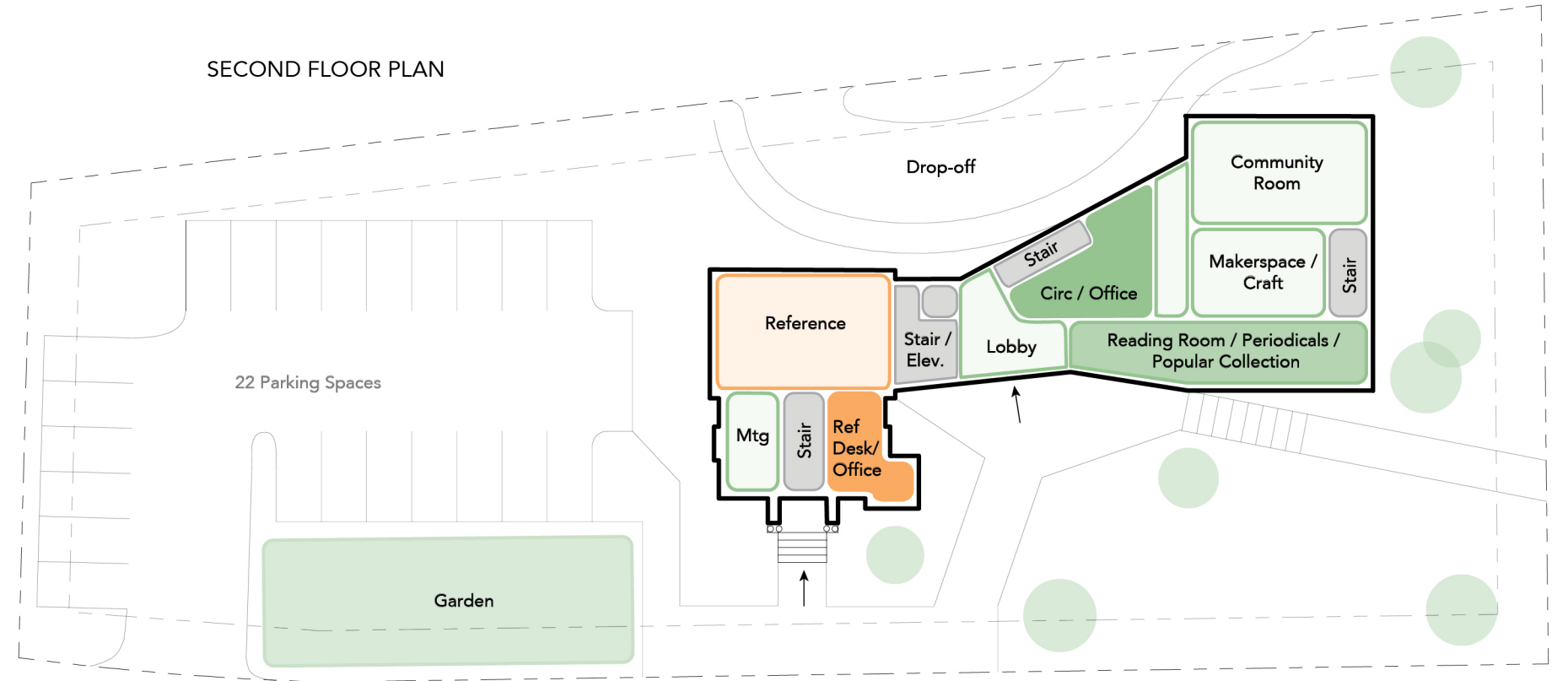

FIRST FLOOR PLAN

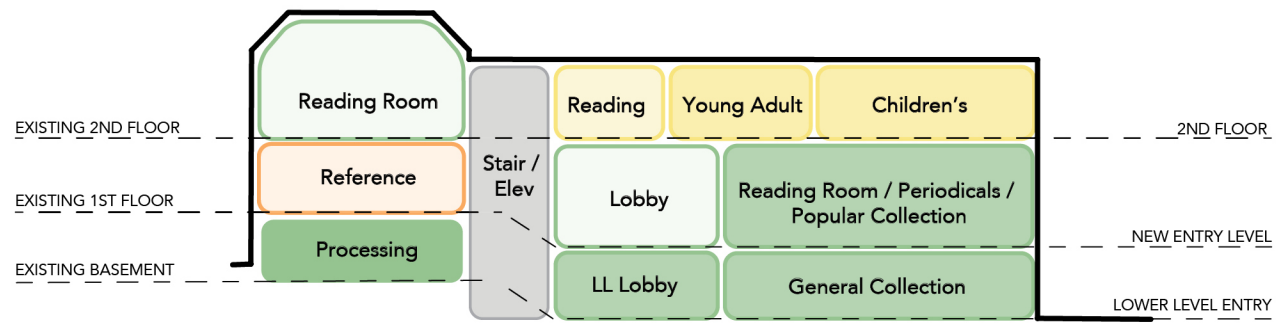

DIAGRAMMATIC BUILDING SECTION

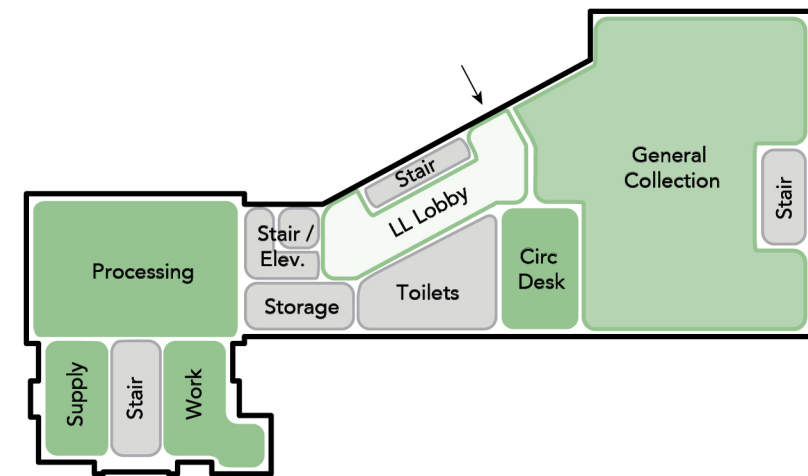

LOWER LEVEL FLOOR PLAN

