

**Design Services
Rice Public Library
KITTERY, MAINE
ADDENDUM 1**

Issued: October 25, 2018

Designers must acknowledge receipt of addenda in their proposal submission.

1. Additional Information Provided (see attached):

- Pre-Conference Meeting Sign-In Sheet
- Energy Analysis
- Assets List of Fixed and Repairs
- LED Lighting Conversion
- Fire Escape Repairs
- Smoke/Heat Detector Circuit Wiring and Placement
- Stonehill Monitoring Well Abandonment
- Asbestos Abatement Project and Supporting Documents

MEETING SIGN-IN SHEET

Project: Rice Library Renovation and Addition Place: Rice Library

Purpose: Design RFP - Preproposal Meeting Date: October 23, 2018

Chair: Jim Anderson Time: 2:30 pm

Print Name	Organization	Title	Best Phone #	E-Mail
JIM ANDERSON	ABC	CHAIR	617-991-2006	jim@rice.edu
PETER MACGOVERN	OAK POINT ASSOCIATES	ARCHITECT	603 431-4849	pmacgovern@oakpoint.com
SETH WILSCHUTZ	SCOTT SIMONS	ARCHITECT	207-772-4656	seth@simonsarchitects.com
Tracy Kozak	JSA Inc	Principal	603-731-5187	tkozak@jsainc.com
BRIAN MURPHY	MANYPENNY MURPHY ARCHITECTURE	ARCHITECT	603.319.8199	brian@manypennymurphy.com
EMILY CHARNIK	MANYPENNY MURPHY	ARCH. DESIGNER	603.319.8199	emily@manypennymurphy.com
CLAY KRAUSE	CMK ARCHITECTS	ARCHITECT	603-627-6510	ckrause@cmkarchitects.com
DEANE RYKERSON	ARQ Architects	ARCHITECT	207-439-8755	deane@arq.comcast.net
ELLEN ANSELONE	FINEGOLD ASSOCIATES	PRINCIPAL	617-227-9272	ellen@finegold.com
Lita Somrak	Port City Architect	Principal	207-761-9000	lita@portcityarch.com
KEVIN MORIN	HOLZMAN MOSS BOTTINO	ARCHITECT	212-465-0808	kmorin@holzmannossbottino.com
MARK ROGERS	Winter Holben	ARCHITECT	207.994.3104	MARK@winterholben.com
Elisa Winter Holben	"	Principal	207 763 3293	elisa@winterholben.com
Will Gatchell	HARRIMAN	ARCHITECT	(603) 723-0878	WGATCHELL@HARRIMAN.com
BOB ROBIKSEK	LAVALUE BRENSINGER	PRINCIPAL	(312) 953.1757	Robert.robiksek@lbpa.com
TAD JUSCZYK	ARCHIPHERNALIA	PRINCIPAL	401-286-6415	TJUSCZYK@ARCHIPHERNALIA.COM
Scott Simons	Scott Simons Architects	IA Architect	207-772-4656	scott@simonsarchitects.com
MIKE CASSEL	"	"		MIKE@CASSELARCHITECTS.COM
BRANDON HOUBEN	WINTER HOUBEN	PRINCIPAL	207.994.3104	brandone@winterhoben.com
PAUL BONACCI	ARQ Architects	Partner	207.439.5286	paul@arqarchitects.com
LUCY SCHLAFFER	ARQ Architects	Partner	207.439.5286	Lucy@arq!

~~Jim Anderson~~

~~LAVALUE BRENSINGER~~

~~617-991-2006~~

~~LAVALUE BRENSINGER~~
arqarchitects.com

RICE PUBLIC LIBRARY

ENERGY ANALYSIS



Energy Analysis

**Rice Public Library
8 Wentworth Street
Kittery, ME 03904
Contact: Lee Perkins
207-332-9795**

Prepared by:

**Alan Rogers
Yankee Thermal Imaging
75 Allen Street
Rochester, NH 03867
603-330-3377**

February 11, 2016



Summary of Work Proposed

Your Energy Summary report addresses the recommendations for improving the comfort, safety and energy efficiency of your home or business. Use this report as a guide for deciding which recommended measures you want to have performed.

Yankee Thermal Imaging is ready to implement these recommendations promptly, and shall guarantee materials and workmanship for two years from the date of installation.

Work Scope Details for Applied Measures:

#	Description and Proposed Measure	Cost
1	<p>Attic:</p> <p>The pre-existing condition is as follows.</p> <p>Ventilation: The attic has a hot roof system in place making ventilation unnecessary.</p> <p>Air barrier: There are many points of heat lose in the attic. This is the most detrimental attribute of the building's energy consumption. The air gaps are located at the attic hatches and on the foam board insulation mounted on the slopes of the attic. The tape on the seams of the foam board insulation have deteriorated over time and are now letting warm conditioned air escape the building.</p> <p>Insulation: The insulation in the attics are made 4" of foam board insulation which has an estimated R-value of R-26 when properly maintained (The seams must be sealed to achieve this R-value). The attic hatches are not insulated. The tower attic has no insulation.</p>	\$3,975.00

	<p>Attic Continued:</p> <p>The following steps should be made to correct the described issues:</p> <ol style="list-style-type: none"> 1. In the upper and lower attics air seal the foam board insulation with foil tape and one-part foam (1800sqft of area). Weather strip the attic hatches (2). Difficult access, fall arrest. (Blower Door: could not depressurize the building, Air Seal 60 units). 2. Install a dam around the tower attic hatch (12sqft of OSB). To prevent insulation from falling into the hatch. 3. Install R-39, 6" of poly-iso insulation board on the tower hatch. 4. Install R-49, 14" cellulose insulation on tower attic flat (64 sqft). 5. Install R-26, 4" of poly-iso insulation board on the emergency hatch. 6. Install poly-iso insulation thermo-dome to prevent heat loss on drop down stairs. 	
2	<p>Basement and Doors:</p> <p>The pre-existing condition is as follows.</p> <p>Air barrier: In the unfinished portion of the basement there are many penetrations connecting the unconditioned space to the conditioned space. Yankee Thermal Imaging was not able to depressurize the building due to the amount of air penetrations.</p> <p>Insulation: The unfinished portion of the basement is uninsulated.</p>	\$2,532.00



	<p>Basement continued:</p> <p>The following steps should be made to correct the described issues:</p> <ol style="list-style-type: none"> 1. Air seal the HVAC, electrical, and plumbing. (Blower Door: could not depressurize the building, Air Seal 20 units). 2. Remove necessary acoustic tiles to gain access to water heater/utility area above the bathroom. Reinstall after work is completed. 3. Install R-13, 2" of 2-part spray foam insulation to foundation walls in the unfinished portion of the basement (mechanical room, server room, and above the bathroom/kitchen drop ceiling from the ceiling to 4' feet down the walls 86 linear feet. 4. Install Intumescent paint on 2-part foam per fire code (344sqft). 5. Install 2" poly-iso widow plugs above the drop ceiling (32sqft) to protect the plumbing from freezing. 	
	<p>Total Cost:</p>	<p>\$6,507.00</p>



1. CUSTOMER'S RESPONSIBILITY TO REMOVE OBJECTS

The customer will prepare his/her home for the work by removing any objects that could be in the contractor's way. If the contractor arrives and proper site preparation has not taken place, then please note that this could cause a delay in work. The Contractor also reserves the right to charge for any additional labor required for site preparation that was not specified in the scope of work.

2. CUSTOMER'S RESPONSIBILITY TO ARRANGE INSTALLATION

The customer agrees to cooperate with contractor in arranging a mutually convenient installation schedule. The customer further agrees to obtain any required permission from their association for any work being done in shared ownership property developments.

3. CUSTOMER'S RESPONSIBILITY TO ALLOW INSPECTIONS

The customer agrees to allow the auditor to return to the job site to verify installation or to conduct one or more post-installation inspections of the work listed in this contract. Customer must allow a post inspection to be completed within 30 days of installation, otherwise your contractor reserves the right to forgo the post installation inspection.

4. CUSTOMER'S PAYMENT

The customer agrees to pay the contractor a deposit of 50% of the estimated total project cost at the time the customer signs this agreement. In addition, the remaining balance is due upon completion of contractor's post installation inspection when all work listed on this contract is complete. Notwithstanding the foregoing, if the customer signing this agreement is a non-occupant owner, the customer must pay the entire Customer Cost Share prior to any work commences.

5. CHANGE ORDERS

If customer requests additional work outside the details of this contract, then your contractor will issue a change order with the additional cost to complete the work. In addition, if the contractor discovers any unforeseen cost during installation that is outside the scope of this workscope, the customer will be notified of such said circumstances. The contractor reserves the right to issue a change order for customer approval if unforeseen circumstances require additional work/costs.

6. DEFECTS IN WORK

Customer should notify the contractor as soon as possible if there are any problems with the quality of the work or materials used The contractor agrees to cure any defects in labor or materials within one year from the original installation date, at no additional cost to the customer.

7. DISCLAIMER OF WARRANTIES/LIMITATION OF LIABILITY

The Contractor offers no warranties other than those written in this contract. Contract disclaims any and all implied warranties to the full extent permitted by law. Contractor excludes any warranty of merchant ability and also excludes any implied warranty of fitness except to the extent of its own negligence. Contractor is not responsible for any damages or losses, or any incidental, special, or consequential damage.

8. EFFECTIVE DATE

This contract is effective after the customer has signed below and dated below. Customer acknowledges that they have read the and understand the contract and any addition information attached.

If customer is in agreement with the terms and conditions of this contract and would like to move forward with the work, then please sign and date below.

Rice Public Library	Yankee Thermal Imaging
<i>Customer Name</i>	<i>Contract Coordinator Name</i>
8 Wentworth Street	75 Allen St. Rochester, NH 03867
<i>Address Where Work Will Be Performed</i>	<i>Contract Coordinator Address</i>
Contact: Lee Perkins	603-330-3377
<i>Customer Phone Number</i>	<i>Contract Coordinator Phone</i>
X	
<i>Customer/Building Owner Signature & Date</i>	<i>Contract Coordinator Signature & Date</i>



RICE PUBLIC LIBRARY

ASSETS

LIST OF FIXED AND REPAIRS

Rice Public Library
Fixed Assets
Schedule of Useful Lives

Category	Asset Type	Useful Life
Buildings	Structures	30
Buildings	Electrical & Plumbing	10
Buildings	HVAC Systems	10
Buildings	Roofs	10
Buildings	Carpeting & Carpet Replacement	7
Infrastructure	Land Improvements	15
Office & Related	Telephone Equipment	5
Office & Related	Furniture	5
Office & Related	Office Equipment	5
Office & Related	Computer Hardware & Software	3
Maintenance	Grounds/Custodial Equipment	5

The capitalization policy of Rice Public Library states that anything purchased under \$1,000 will be expensed in the year it was purchased.

RPL Depreciation Schedule

For the five year period 7/1/09 - 6/30/14

Straight Line

Fixed Assets
Furniture & Equipment

Asset Name	Purchase Date	Purchase Price	Category	Expected Life FYE 6/30/10	Expected Life FYE 6/11 - 6/15
EQUIPMENT					
Telephone System	9/24/2009	4,377.50	Telephone Equipment	10	5
2 Defibrillators Rice and Taylor	10/1/2010	3,098.40	Office Equipment		5
2 New Oil Tanks Rice	8/1/2010	2,930.00	Equipment	11 mos	10
New Rice Book Drop	7/29/2011	4,362.20	Equipment	2012	10
New Furnace at Rice Bldg	10/1/2011	15,000.00	Equipment - HVAC	9 mos 2012	10
Black Bear Signworks	2/1/2015	6,069.99	Sign	5 mos 6/6015	10
Black Bear Signworks	5/22/2015	600.00	Sign addition	1.5 mo 6/2015	10
		50,118.35			

BUILDING REPAIRS & IMPROVEMENTS - RICE

Ayer Electrical	12/1/2010	2,500.00	Smoke Heat Detectors	10 years	10 years
Mike Roneker Electrical	1/3/2012	1,039.00	Roof De-icing cables & accessories	6 mos 2012	7
Art Young	1/11/2013	1,256.00	Patch Leaks In Rice basement Foundation	1/2 mo Jan	7
Rhodes Plumbing Rice	4/17/2013	2,110.00	Floodmaster valves	1/2 mo Apr	7
Mike Roneker Electrical	6/25/2014	1,007.50	New sensor, fan & ductwork - Rice bathrooms	1/2 mo Jun 9 mos	7
Henderson General Contracting	9/26/2014	11,795.00	Fix Gables at Rice	2014	7
Mike Roneker Electrical	3/16/2015	3,952.00	Rice/Taylor Electrical Outside lights & 10 Years Smoke detect in high ceilings	3 1/2 mos 6/2015	7
JSN Associates Engineers	5/29/2015	1,398.00	Plans for fire escape improvement	1 mo 6/2015	7
Art Young Stone Mason	1/1/2016	1,400.00	Re-seal & new cap 1 Chimney Rice	1,400	
Don Goettler general contractor	8/15/2018	1,980.00	Paint 25 windows @ Rice	10 years	
David Noonan Wrought Iron	6/6/2015	18,898.00	Fire escape Reno	00 in 2015	7
Kaloutas	9/1/2016	6,740.00	Paint steel and wrought iron fire escape & Front balcony		
Don Goettler general contractor	2/1/2018	2,240.00	Insulate Attic & Turrett at Rice	20 years	
Total depreciation expense					

Total assets 52,358.35 Total depreciation expense 126,602.65

Building depreciation (no longer being depreciated per audit 6/30/10)
Total accumulated depreciation per GL

Prior Years Capital Improvements

Date	Item	Location	Vendor	Amount
2005	Roof & Gutters	Taylor	Joe Gorman	\$ 10,000
2007	Trim Painted	Taylor	Collegiate Entrepreneurs, Braintree, MA	\$ 4,000
2008	Front & Rear Steps repaired	Taylor	East Coast Masonry, Eliot, ME	\$ 1,440
2008	Roof Repaired	Rice	C. Smith & Sons, Lowell, MA	\$ 14,000
2008	Front steps repaired	Rice	East Coast Masonry, Eliot, ME	\$ 3,950
2009	Phone System Installed	Rice & Taylor	National Telephone and Tech, S. Portland	\$ 4,200
2010	Roof repaired	Rice	C. Smith & Sons, Lowell, MA	\$ 7,200

RICE PUBLIC LIBRARY

LED LIGHTING CONVERSION

Michael Roneker Electrical Contractor LLC

Estimate

414 Ocean Road
Portsmouth, NH 03801
603-765-2066

Date	Estimate #
1/18/2017	53

Name / Address
Rice Public Library 8 Wentworth St. Kittery, ME 03904

Item	Description	Total
EST. LABOR	Estimated labor to remove existing ceiling fluorescent light fixtures in Rice Library & Taylor Building basement and install new LED replacement fixtures	3,300.00
ESTIMATED COST	4' LED fluorescent replacement fixtures, 4' & 3' LED single lamp indirect cove light fixtures, 2' LED troffer drop in ceiling fixtures, 6" LED recessed trim kits, mounting hardware, connectors	6,200.00
Total		\$9,500.00

RICE PUBLIC LIBRARY

FIRE ESCAPE REPAIRS

DAVID NOONAN WROUGHT IRON LLC.

497 Hooksett Rd. #264

Manchester, NH 03104

603-703-3771

www.wroughtironnh.com

9/25/2015

Proposal for

Rice public library

Kittery, Maine

Attn. Lee Perkins

Pour a cement pad / landing for under the fire escape stairs. Remove chains and weight and discard. Drop fire escape stairs to cement pad and secure. Fabricate new expanded metal door and wall section to secure stairs from anyone climbing up the stairs. The door will have a panic push bar type opener on inside of door lockable from the outside. Also we will fasten expanded metal to the two newly installed I-beams to prevent anyone from climbing the cross supports. All of this will also be primed and painted.

Total cost \$3200.00

I will accept the first half of \$1600. For materials and labor and donate the 2nd balance of \$1600. to the non-profit Rice Library.

Thanks again and please call with any questions.

Dave Noonan

RICE PUBLIC LIBRARY

**SMOKE/HEAT DETECTOR
CIRCUIT WIRING AND
PLACEMENT**



The Rice Public Library

SMOKE / HEAT DETECTOR CIRCUIT WIRING AND PLACEMENT

December 10, 2010

THE RICE BUILDING

- **THE BASEMENT** HAS SMOKE DETECTORS IN THE FURNACE ROOM AND PERIODICALS ROOM, AND A HEAT DETECTOR IN THE KITCHEN
- **THE MAIN LEVEL** HAS 5 SMOKE DETECTORS - TWO OF WHICH ARE WIRELESS RF INTERCONNECTED, AND THREE WIRE-INTERCONNECTED. THE WIRELESS RF INTERCONNECTED SMOKE DETECTORS ARE ABOVE THE CHECK OUT DESK, AND OUTSIDE THE BATHROOM (DUE TO A BAD INTERCONNECT WIRE BETWEEN THESE TWO LOCATIONS).
- **THE SECOND FLOOR** HAS THREE SMOKE DETECTORS - ONE EACH, IN THE STAIRWELL, BIG ROOM, AND REFERENCE ROOM
- **THE ATTIC** OF THE LIBRARY HAS TWO HEAT DETECTORS IN THE ROOMS IMMEDIATELY ADJACENT TO THE AREA WITH THE PULL-DOWN STAIRS, AND A SMOKE DETECTOR IN THE ATTIC SPACE ABOVE THE BIG ROOM OF THE SECOND FLOOR

LEGAND

WIRELESS AC/DC RF INTERCONNECT SMOKE DETECTORS



REGULAR AC/DC SMOKE DETECTORS



REGULAR AC/DC HEAT DETECTORS



- THE DRAWN BLUE LINES INDICATE THE CIRCUIT WIRING PATH.
- THE SMOKE/HEAT DETECTOR CIRCUIT IS CIRCUIT 18 IN THE ELECTRICAL PANEL.

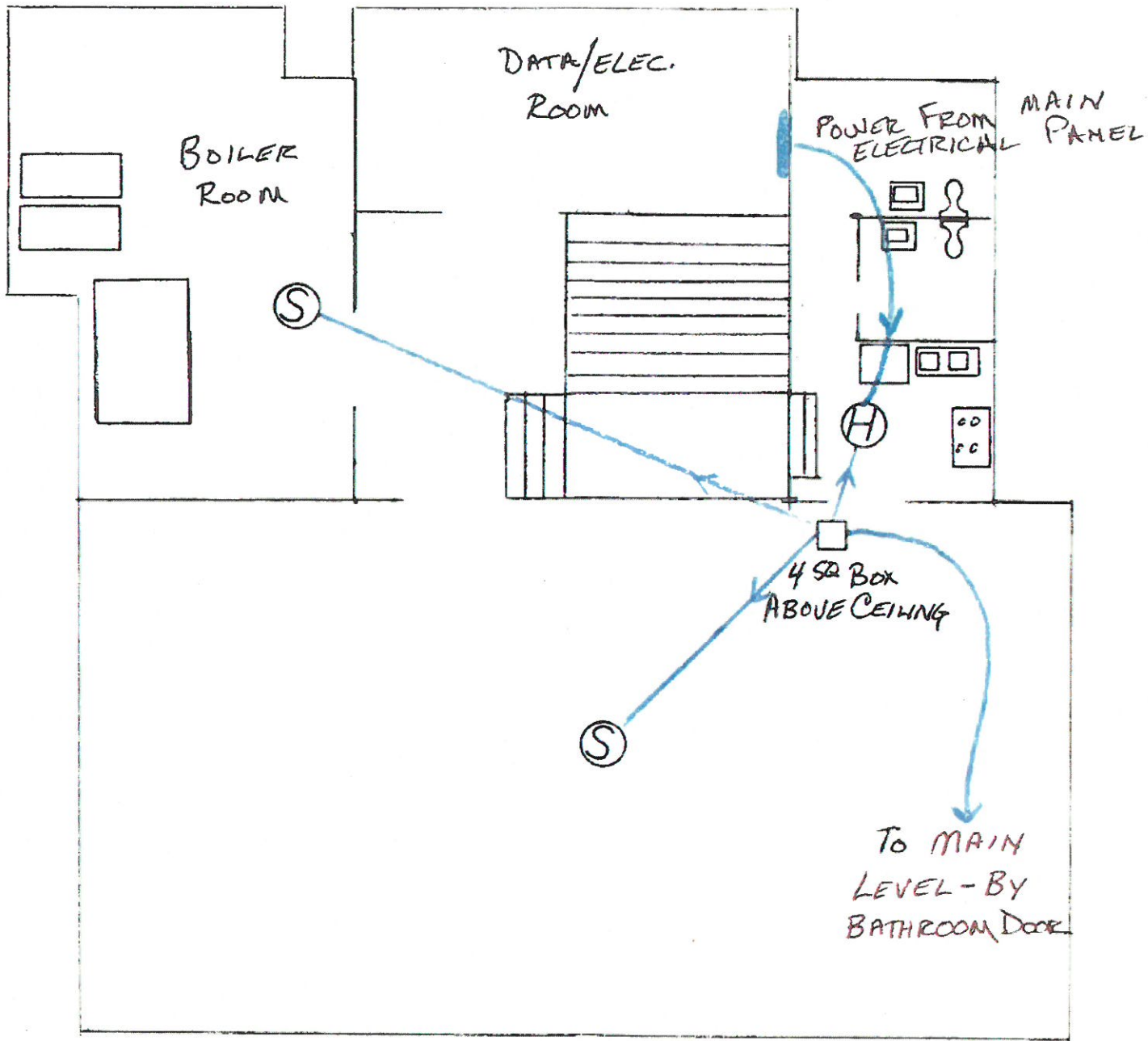

BASEMENT LEVEL

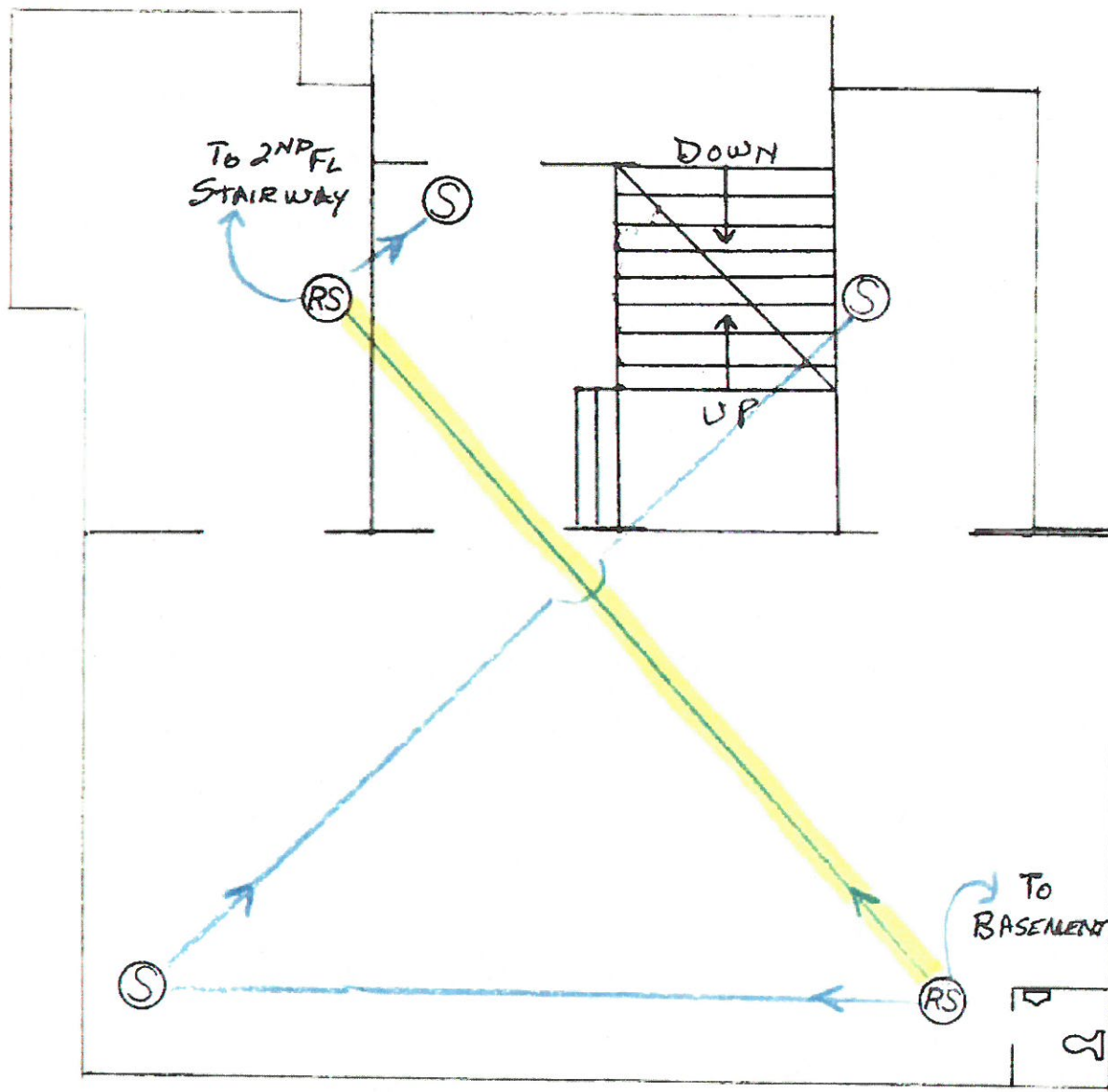

MAIN LEVEL

* BAD RED INTER-CONNECT CONDUCTOR IS DENOTED BY YELLOW HIGHLIGHTER

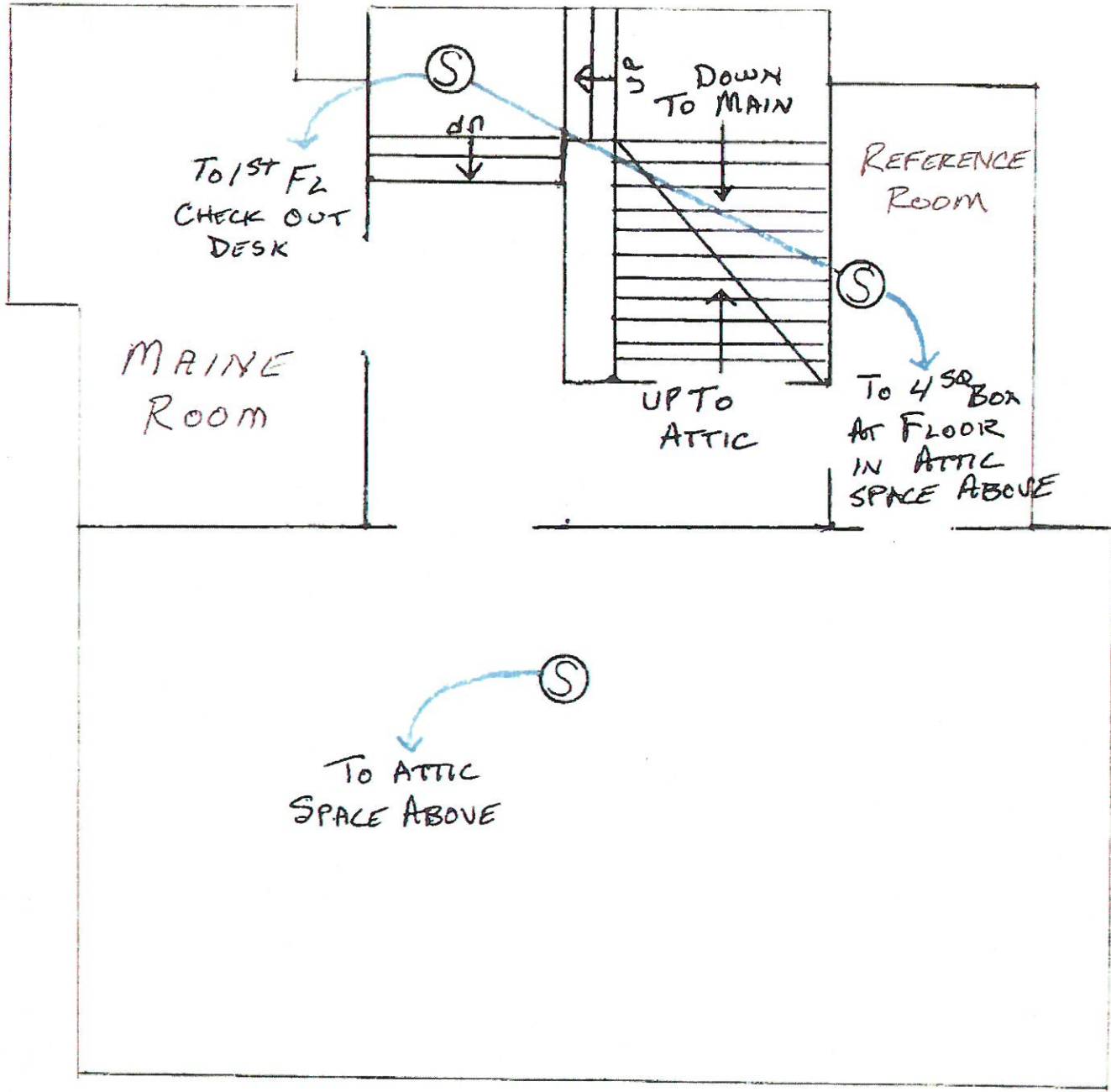

SECOND FLOOR

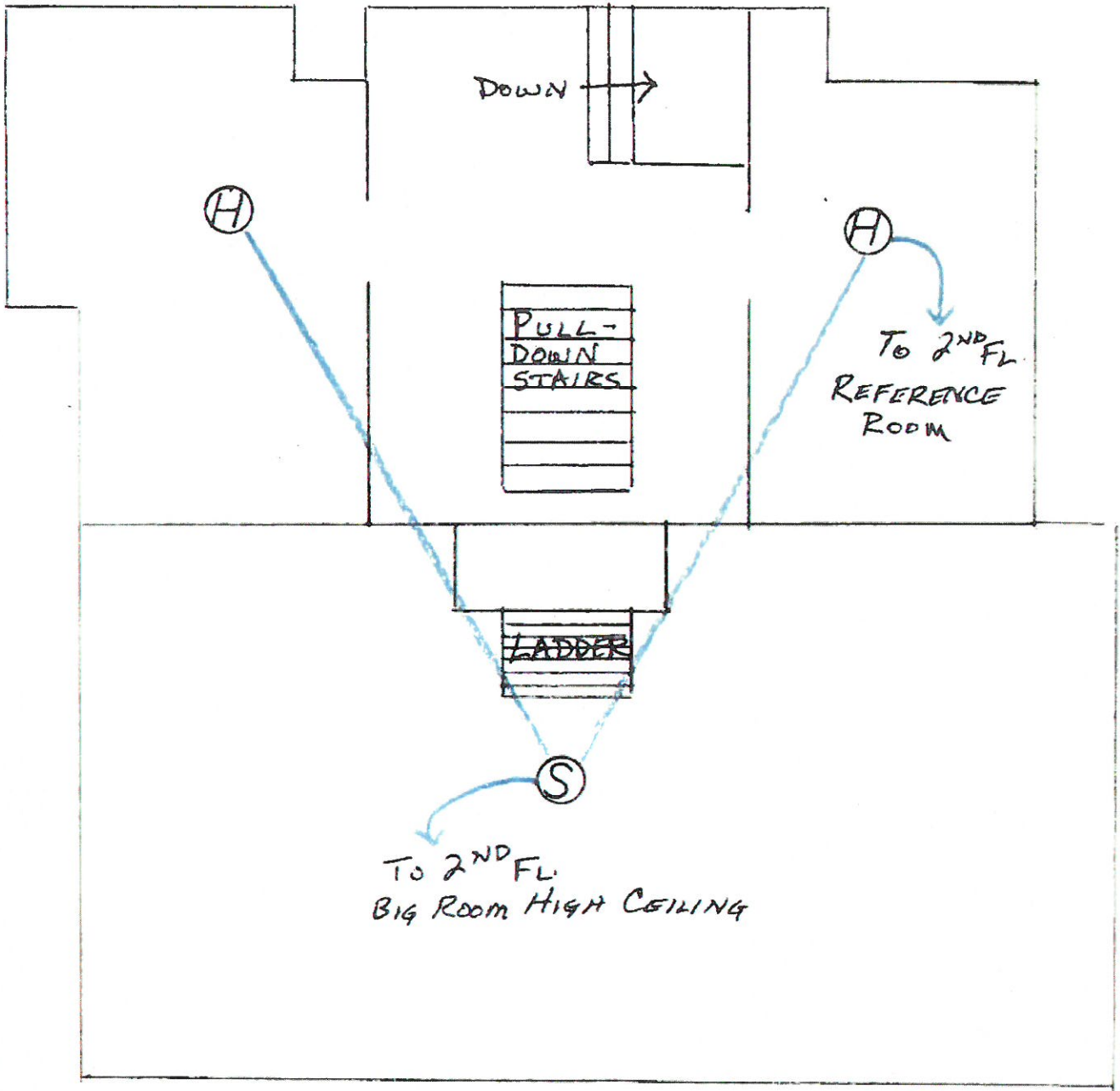

ATTIC

RICE PUBLIC LIBRARY

STONEHILL

MONITORING WELL

ABANDONMENT



StoneHill
Environmental, Inc.

600 State Street, Suite 2
Portsmouth, NH 03801
tel 603-433-1935
fax 603-433-1942

July 10, 2018

Lee Perkins, MLIS
Director Rice Public Library
8 Wentworth Street
Kittery, ME 03904

RE: Monitoring Well Abandonment

Dear Ms. Perkins:

In response to your request, StoneHill conducted a site visit to inspect the locations of two groundwater monitoring wells on the Rice Library property which had been damaged. The overburden monitoring well MW-9 was located in a lawn area north of the library and the shallow bedrock monitoring well MWB-1 was located farther to the north adjacent to the south edge of the asphalt paved parking lot. The approximate well locations are shown on the enclosed aerial photograph. Monitoring well MW-9 was observed to be missing its protective cover and filled with soil. The protective flush mounted road-box cover for monitoring well MWB-1 was observed to have been pulled from the ground; reportedly having been struck by a snow plow over the winter months. The well casing left in the ground could not be located and presumably was also damaged and inadvertently filled with soil. Due to the conditions observed in the field, it is appropriate to consider that the wells have been abandoned and any remnants of well casing encountered in the ground can be removed and the former well locations landscaped or paved as necessary.

Please note that an additional shallow bedrock monitoring well, MWB-3, is located on the Rice Library property approximately 15 feet south of the southeast corner of the library building. Ideally the integrity of this well should be maintained. However, if in the future it is necessary to destroy this monitoring well due to on-site construction or other activities, the well should be abandoned in accordance with Maine Department of Environmental Protection guidance for well abandonment.

Please do not hesitate to contact us if you have any questions.

Sincerely,
StoneHill Environmental

Timothy Stone, PG
Principal

Enclosure: Aerial Photo with Well Locations

Monitoring Well Locations

103

Legend

⊙ Approximate Well Location



RICE PUBLIC LIBRARY

**ASBESTOS ABATEMENT
PROJECT AND SUPPORTING
DOCUMENTS**



NORTHEAST TEST CONSULTANTS

April 12, 2013

Ms. Lee Perkins
Rice Public Library
8 Wentworth Street
Kittery, Maine 03904

RE: Waste Manifests
NTC Job #'s 13287-2012

Dear Ms. Perkins:

Enclosed please find copies of the Waste Disposal Receipts documenting transportation and receipt of Asbestos Containing Materials to Waste Management of Maine in Portland, Maine.

Please attach these copies to your documentation and reports regarding these projects.

Should you have any questions, please don't hesitate in calling.

Sincerely,



A handwritten signature in black ink, appearing to read "J. Boilard", is written over a large, circular, scribbled-out area. The signature is fluid and cursive.

John M. Boilard
Operations Manager

JMB: ccs

Enclosure

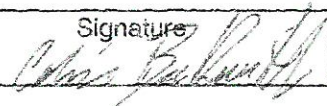
WASTE SHIPMENT RECORD NTC # 13287-2012

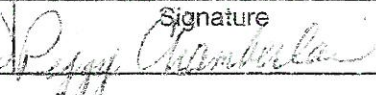
GENERATOR	1. Work site (Generator): Name <u>Rice Public Library</u> Mailing Address <u>8 Wentworth St.</u> City/State/Zip <u>Kittery, ME 03904</u>		Owner's Name <u>M. Lee Perkins</u>	Owner's telephone no. <u>207-439-1553</u>		
	2. Remover's name and address: <u>ABRAM ENVIRONMENTAL</u> <u>PO Box 2038 Windham, ME 04062</u>			Remover's telephone no. <u>207-892-7045</u>		
	3. Waste Disposal site (WDS): Name <u>Waste Management of ME</u> Mailing Address <u>PO Box 629</u> City/State/Zip <u>Norridgewock, ME 04957</u>		WDS telephone no. <u>800-562-7779</u>	Additional Information: Profile No. 1 0 0 6 8 7 ME		
	Physical Site Location <u>US Rt. # 12</u> <u>Norridgewock, ME 04957</u>					
	4. Name and address of responsible agency <p style="text-align: center; font-size: 1.2em;"><u>MAINE DEP Asbestos Division</u></p>					
	5. Description of materials <u>RQ, ASBESTOS, 9, NA2212, III</u> <u>RQ = 1 LB (ONE POUND)</u>		6. Containers No. <u>8</u> Type <u>Bags</u>	7. Total quantity <u>1 yd³</u>		
	8. Special handling instructions and additional information (provided by generator.) * EMERGENCY RESPONSE NUMBER: (800) 645-8265					
	9. OPERATOR'S CERTIFICATION: I hereby declare that the contents of this consignment are fully and accurately described above by proper shipping name and are classified, packed, marked, and labeled, and are in all respects in proper condition for transport by highway according to applicable international and government regulations. NOTE: Generator must retain a copy of this form.					
	Printed/typed name & title <u>Colin Beckwith</u>		Signature 	Month	Day	Year
			<u>10</u>	<u>15</u>	<u>12</u>	
TRANSPORTER	10. Transporter 1 (Acknowledgement of receipt of materials)					
	Printed/typed name & title <u>Colin Beckwith President</u>		Signature 	Month	Day	Year
	Address and telephone no. <u>PO Box 2038 Windham, ME</u> <u>892-7045</u>			<u>10</u>	<u>15</u>	<u>12</u>
	11. Transporter 2 (Acknowledgement of receipt of materials)					
Printed/typed name & title <u>Jay Estabrook</u>		Signature 	Month	Day	Year	
Address and telephone no. <u>2000</u>			<u>3</u>	<u>5</u>	<u>13</u>	
DISPOSAL SITE	12. Discrepancy indication space		Rejected: Yes <input type="checkbox"/> No <input type="checkbox"/>			
	13. Waste disposal site owner or operator: Certification of receipt of asbestos materials covered by this manifest except as noted in item 12.		<u># 2958</u>	<u>11/26</u>	<u>6/3/13</u>	
	Printed/typed name & title <u>WMS of M. Peggy Chamberlain (owner)</u>		Signature 	Month	Day	Year
			<u>3</u>	<u>5</u>	<u>13</u>	



NORTHEAST TEST CONSULTANTS

ASBESTOS ABATEMENT PROJECT

at

**BASEMENT PIPE INSULATIONS
KAY HOWELL ROOM, RESTROOM, & JANTOR'S ROOM
RICE PUBLIC LIBRARY
8 WENTWORTH STREET
KITTERY, MAINE**

NTC JOB #13287-2012

Prepared by:

**NORTHEAST TEST CONSULTANTS
587 SPRING STREET
WESTBROOK, ME 04092**

Prepared for:

*Ms. Lee Perkins
Rice Public Library
8 Wentworth Street
Kittery, Maine 03904*

October 24, 2012



NORTHEAST TEST CONSULTANTS

October 24, 2012

Ms. Lee Perkins
Rice Public Library
8 Wentworth Street
Kittery, Maine 03904

RE: Asbestos Abatement Actions
Rice Public Library
Pipe Insulation & Fittings
NTC Job #13287-2012

Dear Ms. Perkins:

Please find attached the project documentation for the Asbestos Abatement Actions conducted by *Northeast Test Consultants* with Abram Environmental, LLC on October 15, 2012 for the Basement Areas of the Rice Public Library located at 8 Wentworth Street in Kittery, Maine.

More specifically, abatement operations were comprised of the proper removal of a total of approximately one hundred two (102) linear feet of asbestos containing thermal system insulations (*pipe covering & fittings*) from the Kay Howell Room, Restroom and Janitor's Room.

Removal of asbestos pipe covering materials was performed within posted asbestos regulated work areas, by the use of multiple glove bag removal techniques with a remote decontamination facility utilizing wet methods, HEPA vacuuming, and proper personal protective equipment.

All work operations were performed in compliance with the asbestos regulations as set forth in both *OSHA* 29 CFR Part 1926.1101; US EPA Title 40 – CFR, Part 61 NESHAP, Subparts A and M (General Provisions and Asbestos Standards, respectively); & *State of Maine* DEP Regulations, Chapter 425, effective 4-3-2011.

During the project, *Northeast Test Consultants* conducted concurrent air sampling inside and outside of the asbestos regulated work areas and performed post abatement activity visual inspection of abated areas so as to ensure compliance with both State and Federal guidelines.

Onsite airborne sample analysis was performed utilizing NIOSH Method #7400 for Phase Contrast Microscopy. A total of four (4) area samples (2 field blanks) were collected and analyzed during this abatement project.

Sampling data showed all collected samples to have airborne levels below the permissible exposure limit of 0.1 fibers per cubic centimeter (<0.1 f/cc) of air as set forth in *OSHA* 29 CFR 1910.1001 and *OSHA* 29 CFR 1926.1101 at the time of sampling.

Area samples collected were also below the *Environmental Protection Agency's* (EPA) criteria of less than 0.01 f/cc for area occupancy after abatement activities.

A total of ten (10) bags of asbestos containing waste were generated during this activity. Waste materials were properly packaged and labeled and then transported off-site pending transportation and final disposal at an approved asbestos landfill facility.

This project report includes all analytical data, project daily checklist, field log, visual inspection form, project completion checklist, design plan, and the asbestos project notification paperwork, including revisions submitted to the ME DEP.

Also incorporated with this report is a copy of the generated Waste Manifest with completed information to date. A completed Waste Manifest form will be forwarded to you following final destination and disposition at the landfill facility.

Should you have any questions regarding this report, please give me a call.

Sincerely,

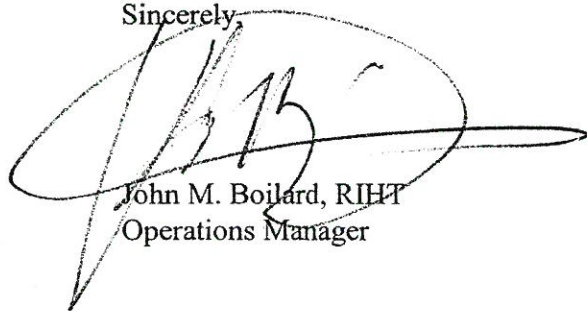
A handwritten signature in black ink, appearing to be 'J. Boilard', is written over a large, faint oval shape. The signature is fluid and cursive.

John M. Boilard, RIHT
Operations Manager

Attachments



NORTHEAST TEST CONSULTANTS

October 24, 2012

Ms. Lee Perkins
Rice Public Library
8 Wentworth Street
Kittery, Maine 03904

Re: *Asbestos Air Sample Analysis*
Rice Public Library
Pipe Insulation & Fittings
NTC Job #13287-2012

Dear Mr. Mercier:

Please find enclosed the analytical results for the airborne samples collected on October 15, 2012.

Analysis for the numbers of fibers, longer than 5 microns and with an aspect ratio of 3:1 or greater, was performed by Phase Contrast Microscopy (PCM) technique at 400-X magnification. The method of analysis is per the National Institute for Occupational Safety and Health Method #7400, Issue Two, and Dated 08/15/94.

This method (NIOSH Method #7400) is an approved analytical procedure for the American Industrial Hygiene Association – PAT Program for Asbestos Fiber Counting. NIOSH Method #7400 does not differentiate between asbestos and non-asbestos fibers that meet the dimensional criteria of the method.

Should you have any questions regarding the analytical results, please contact me.

Sincerely,



John M. Boilard, RIHT
Operations Manager

Attachments



NORTHEAST TEST CONSULTANTS

587 SPRING STREET
WESTBROOK, MAINE 04092
(207) 854-3939

Indoor Air Quality Management
Asbestos & Lead Monitoring
Industrial Hygiene Consultants
Compliance Training

AIRBORNE FIBER MONITORING REPORT

Client: Rice Public Library
8 Wentworth Street
Kittery, ME 03904

P.O. # NTC Job # Report Date

 13287-2012 10/24/2012

NTC Sample #	Sample Description	Type	Fibers/CC.	Remarks
A2289030	Sampled: 10/15/2012 By: Brian Cohen Analyzed: 10/15/2012 By: Brian Cohen LPM: 0.00 Total Volume: Field/Client Designation: A-1 Basement	Blank	N/A	0 Fibers in 100 Fields
A2289031	Sampled: 10/15/2012 By: Brian Cohen Analyzed: 10/15/2012 By: Brian Cohen LPM: 0.00 Total Volume: Field/Client Designation: A-2 Basement	Blank	N/A	0 Fibers in 100 Fields
A2289032	Sampled: 10/15/2012 By: Brian Cohen Analyzed: 10/15/2012 By: Brian Cohen LPM: 10.00 Total Volume: 2550.0 Field/Client Designation: A-3 Basement Kay Howells Room Inside Regulated Area	Area	< 0.01	

Analysis Method Unless noted in sample remarks: Analysis by Phase Contrast Microscopy at 400X as per NIOSH Method 7400, Issue 2, August 15, 1994.

This report only refers to the sample analyzed and is not necessarily denotative of the quality or condition of overtly identical or similar products. This report is submitted and approved for the private use of the client to whom it is addressed. It is not to be used, in part or in whole, in any advertising without prior written authorization from NTC. Sample types, locations and collection properties are based upon the information provided by the persons submitting them and, unless collected by NTC personnel, we explicitly disclaim any knowledge and liability for the accuracy of this data. All rights reserved by Northeast Test Consultants, Westbrook, Maine.

Approved By: 10/24/12 S.Broadhead



NORTHEAST TEST CONSULTANTS

587 SPRING STREET
WESTBROOK, MAINE 04092
(207) 854-3939

Indoor Air Quality Management
Asbestos & Lead Monitoring
Industrial Hygiene Consultants
Compliance Training

AIRBORNE FIBER MONITORING REPORT

Client: Rice Public Library
8 Wentworth Street
Kittery, ME 03904

P.O. #	NTC Job #	Report Date
	13287-2012	10/24/2012

NTC Sample #	Sample Description	Type	Fibers/CC.	Remarks
A2289033	Sampled: 10/15/2012 By: Brian Cohen Analyzed: 10/15/2012 By: Brian Cohen LPM: 10.00 Total Volume: 2550.0 Field/Client Designation: A-4 Basement Kay Howells Room Outside Regulated Area	Area	< 0.01	

Analysis Method

Unless noted in sample remarks: Analysis by Phase Contrast Microscopy at 400X as per NIOSH Method 7400, Issue 2, August 15, 1994.

This report only refers to the sample analyzed and is not necessarily denotative of the quality or condition of overtly identical or similar products. This report is submitted and approved for the private use of the client to whom it is addressed. It is not to be used, in part or in whole, in any advertising without prior written authorization from NTC. Sample types, locations and collection properties are based upon the information provided by the persons submitting them and, unless collected by NTC personnel, we explicitly disclaim any knowledge and liability for the accuracy of this data. All rights reserved by Northeast Test Consultants, Westbrook, Maine.

Approved By: 10/24/12 S.Broadhead



NORTHEAST TEST CONSULTANTS

PROJECT DAILY FIELD LOG

DATE: 10/15/12 TIME: 800 INDUSTRIAL HYGIENIST: BRIAN COHEN
 PROJECT: RICE LIBRARY, FITTING Y, T.S.I. ABATONEN NTC Job #: 13207-12

CHECK LIST	OK	CHECK ANY DEFICIENCIES	REMARKS
CONTAINMENT BARRIERS	<u>N/A</u>	---	<u>ABRAM ENV.</u>
SIGN POSTING AT WORKSITE	<u>✓</u>	---	
NUMBER OF CONTRACTOR'S PERSONNEL	<u>✓</u>	---	<u>COLIN BECKWITH</u>
CONTRACT SUPERVISION ON SITE	<u>✓</u>	---	<u>NTC</u>
HEPA DISCHARGE SAMPLED	<u>N/A</u>	---	<u>BRIAN COHEN</u>
Δ PRESSURE MONITOR READOUT	<u>N/A</u>	---	<u>WASTE</u>
DECONTAMINATION AREA	<u>✓</u>	---	<u>10 BAGS</u>
WASTE DOUBLE BAGGED (6 MIL) & LABELED	<u>✓</u>	---	
INSPECTIONS BY EPA, DEP, OTHER (SPECIFY)	<u>N/A</u>	---	
PERMITS AND SUBMITTALS	<u>✓</u>	---	
CLEARANCE AIR TESTS	<u>N/A</u>	---	
FINAL AIR TESTS	<u>N/A</u>	---	
VISUAL INSPECTION OF WORKPLACE	<u>✓</u>	---	

ALL OTHER INFORMATION REGARDING PROJECT EVENTS RECORD BELOW.	
TIME	EVENTS INFORMATION
<u>800</u>	<u>ABRAM ENVIRONMENTAL ON-SITE.</u>
<u>815</u>	<u>LOAD IN EQUIPMENT. BEGIN DECON SET-UP. AREA FOR CONNAC SET-UP</u>
<u>1130</u>	<u>SETUP COMPLETE, BREAK</u>
<u>1200</u>	<u>BEGIN REMOVAL</u>
<u>1630</u>	<u>REMOVAL, CLEANING, TIE-DOWN COMPLETE</u>
<u>1845</u>	<u>AE, NTC OFF-SITE</u>

SIGNATURE: 



NORTHEAST TEST CONSULTANTS

Date: 10/15/11
Page: 1 Initials: BC

FIELD LOG

Job: RICE PUBLIC LIBRARY; T.S.I. ABATEMENT

Time	Events
800	ABRAM ENVIRONMENTAL ON-SITE. LEE PECKINS UNLOCKS DOOR. WILL RETURN @ 5 P.M. TO RELOCK.
815	LOAD IN DQ. WILL BUILD DECON IN BASEMENT. PLAN TO DO REMOVAL IN "KAY HINWEL'S ROOM" FIRST.
1130	DECON ^{SETUP} COMPLETE. REMOVAL AREA SET-UPS COMPLETE (DEP FLOORS, PRE-CLEANING ETC) WILL HANG GLOVES BAGS WHILE SET-UPS IN BATHROOM AREA JUST PRIOR TO REMOVAL
1200	BEGIN REMOVAL
1600	VISUALS OKAY, REMOVALS COMPLETE, TEAR-DOWN DECON
1630	TEAR-DOWN COMPLETE
1645	NOTIFY STAFF OF DEPARTURE, NTC, & OFF-SITE.

Date: October 15, 2012

VISUAL INSPECTION OF ASBESTOS ABATEMENT WORK AREA

NTC JOB #: 13287-2012 PROJECT: T.S.I. Abatement

CLIENT: Rice Public Library LOCATION: Basement

1st Attempt X 2nd Attempt 3rd Attempt Passed: Yes X No

Area Satisfactorily Encapsulated? Yes No N/A X

Wipe Samples Collected? Yes No N/A X

	<u>Inspection List</u>	<u>OK</u>	<u>N/A</u>	<u>Deficiencies: List Below</u>
A.	Floor(s)	<u>X</u>	<u> </u>	<u> </u>
B.	Horizontal Surfaces	<u>X</u>	<u> </u>	<u> </u>
C.	Pipe Lengths	<u>X</u>	<u> </u>	<u> </u>
D.	Lagging	<u>X</u>	<u> </u>	<u> </u>
E.	HVAC Equipment	<u> </u>	<u>X</u>	<u> </u>
F.	Boiler, Breeching, etc.	<u> </u>	<u>X</u>	<u> </u>
G.	Stairs	<u> </u>	<u>X</u>	<u> </u>
H.	Lighting Fixtures	<u>X</u>	<u> </u>	<u> </u>
I.	Non Porous Surfaces	<u>X</u>	<u> </u>	<u> </u>
J.	Associated Wiring	<u> </u>	<u>X</u>	<u> </u>
K.	Sprinkler System	<u>X</u>	<u> </u>	<u> </u>
L.	Mechanical Equipment	<u> </u>	<u>X</u>	<u> </u>
M.	Pipe/Wall Intersections	<u>X</u>	<u> </u>	<u> </u>
N.	Staging & Planks	<u> </u>	<u>X</u>	<u> </u>
O.	Bolts, Threads, etc.	<u>X</u>	<u> </u>	<u> </u>
P.	Other	<u> </u>	<u>X</u>	<u> </u>

Field Notes: Abram Environmental removed 102 linear feet of Asbestos Pipe Covering, via multiple glovebags. The pipes are free of any visible dust and debris. It is okay to deregulate.

Industrial Hygienist: Brian Cohen

Date: October 15, 2012

PROJECT COMPLETION CHECKLIST

NTC JOB #: 13222-2012 PROJECT: Basement T.S.I. Abatement

CLIENT: Rice Public Library CONTACT: Lee Perkins

1. Passed Final Visual Inspection; Date: October 15, 2012
2. Clearance Air Sample Results; Range N/A
3. Encapsulant Overspray Excessive: Yes No N/A
If yes, where. _____
4. Housekeeping Acceptable? Yes No
5. Outside Landscaping Acceptable? Yes No N/A
6. Waste Storage Dumpster Locked? Yes No N/A
7. Number of Bags Disposed? 10
8. Damage due to abatement? Yes No
If yes, where. _____
9. Contractor Released? Time 1630
10. Keys transferred to building owner? Yes No N/A
11. Owner's representative notified of project completion and contractor's departure? Yes No
If no, then who. _____

Field Notes: Notify library staff.

Industrial Hygienist: Brian Cohen



NORTHEAST TEST CONSULTANTS

DESIGN PLAN
for
ASBESTOS ABATEMENT

at

BASEMENT PIPE INSULATIONS
KAY HOWELL ROOM, RESTROOM, & JANTOR'S ROOM
RICE PUBLIC LIBRARY
8 WENTWORTH STREET
KITTERY, MAINE

NTC JOB #13287-2012

Prepared by:

NORTHEAST TEST CONSULTANTS
587 SPRING STREET
WESTBROOK, ME 04092

Prepared for:

Ms. Lee Perkins
Rice Public Library
8 Wentworth Street
Kittery, Maine 03904

October 2, 2012

DESIGN CERTIFICATION

NTC Job #: 13287-2012
Owner: Rice Public Library
Project: Basement Areas
Kay Howell Room, Restroom, & Janitor's Room
Asbestos Pipe Covering & Fittings

Project Designer of Record:

John M. Boilard; *ME DEP DC-0260*
Design Consultant

Signature

10 / 2 / 2012
Date

Air Monitor:

John M. Boilard; *ME DEP AM-0037*
Air Monitor

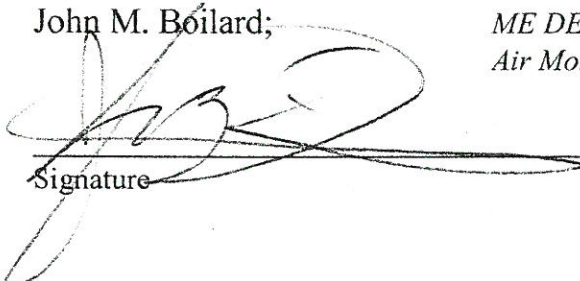
Signature

10 / 2 / 2012
Date

Asbestos Inspector:

N/A *ME DEP AI-*
Asbestos Inspector

N/A
Signature

N/A
Date

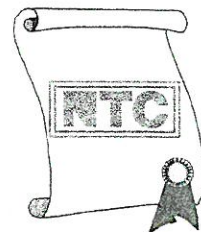

Owner: RICE PUBLIC LIBRARY

NTC Job #: 13287-2012

Notification by: Northeast test Consultants
NOTI#: NTC 13287-2012

Project: Basement Areas
Kay Howell Room, Restroom, & Janitor's Room
Asbestos Pipe Covering & Fittings

Designer: John M. Boilard; *ME DC-0260*
Design Consultant

Scope :

The following project involves the removal of a total of approximately one hundred two (102) linear feet of asbestos containing thermal system insulations (*pipe covering & fittings*) from the Basement Areas of the Rice Public Library located at 8 Wentworth Street in Kittery, Maine.

More specifically, abatement operations will be conducted in the Kay Howell Room, Restroom, & Janitor's Room.

Removal of asbestos pipe covering materials will be performed by use of multiple glove bag removal techniques with contiguous and/or remote decontamination facility utilizing wet methods, HEPA vacuuming, and proper personal protective equipment.

All work operations shall be in compliance with the asbestos regulations as set forth in both *OSHA* 29 CFR Part 1926.1101; US EPA Title 40 – CFR, Part 61 NESHAP, Subparts A and M (General Provisions and Asbestos Standards, respectively); & *State of Maine* DEP Regulations, Chapter 425, effective 4-3-2011.

The work specified shall be performed by certified personnel (*State of Maine*) knowledgeable and qualified in the techniques of asbestos abatement including removal, handling and disposal of asbestos material along with subsequent cleaning of asbestos contaminated areas.

All personnel working on the project should have available for review a submittal package, with up-to-date data, consisting of the following: **1)** State Certification, **2)** Medical Monitoring, **3)** Respirator Fit Test, and **4)** Training Certificates.

Any of the Contractor's personnel not having all sections of the submittal package should not be allowed to work on the project.

The Abatement Contractor shall maintain the following additional onsite required documentation:

- a.) This Design Plan (NTC Job #13287-2012, dated 10/2/2012),
- b.) Asbestos Project Notification (#NTC 13287-2012)
- c.) The most recent copy of the ME DEP Asbestos Regulation, Chapter 425,
- d.) Bulk Disclosure forms (*if required*)
- e.) Project Monitoring Disclosure forms (*if required*)

The Contractor shall supply all labor, materials, services, insurance, and equipment necessary to carry out the work in accordance with all applicable Federal, State, and Local Regulations and these Specifications.

Northeast Test Consultants will perform Project Oversight, Area Monitoring and Visual Inspection for release of the work areas associated with this project.

GENERAL REQUIREMENTS

Part 1 - Responsibilities

Owner:

The Owner will be responsible for providing availability to potable water and electricity to the abatement contractor for these activities.

Abatement Contractor:

The Abatement Contractor shall supply all labor, materials, services, insurance, and other equipment necessary to carry out the asbestos related work operations in accordance with all applicable Federal, State, and Local Regulations and these Specifications.

Part 2 - Safety Concerns

The use of ground fault circuit interrupter (*GFCI*) outlets is required for electrical equipment.

Step Ladders.

Slips, trips, and falls – poly sheeting drop cloths on floors.

Part 3 - HEPA Equipped Equipment

Vacuums used for clean-up operations shall be *HEPA* equipped and meet the following requirements:

- i. Vacuum units must be operated in accordance with *US EPA* recommendations set forth in Appendix J of the *US EPA* Guidance Document : EPA 560/5-85-024 (effective June, 1985);
- ii. The intake air tubes must be fiber-tight and securely attached to the *HEPA* vacuum intake port.

Part 4 - Pre Cleaning

Pre-clean any areas as necessary to install critical barriers or establish drop cloths.

Visible asbestos-containing debris that is present on surfaces upon which the contractor will place polyethylene sheeting to establish any regulated area shall be cleaned up prior to conducting set-up, removal, or repair activities.

Part 5 - Critical Barriers

Install critical barriers consisting of one layer of 6-mil polyethylene sheeting over all windows, doorways, wall penetrations, and all other openings located in the immediate abatement work area when applicable.

Sheeting shall be sealed by utilization of duct tape with spray glue, if necessary.

Part 6 - Decontamination Facility

Utilize the three (3) stage decontamination facility consisting of an equipment room, shower room, and clean room established either contiguous to the work areas or remotely situated as needed.

The shower unit must include an adjustable hot and cold-water mixture valve, hot and cold water, soap, towels, and a mechanism of collecting and containing shower water for treatment with a 5-micron filter prior to discharge.

The clean room must be a minimum of 24 square feet for projects involving 3 or fewer certified individuals entering the regulated area per work shift and a minimum of 32 square feet for all other projects.

The clean room must be a minimum of 24 square feet for projects involving 3 or fewer certified individuals entering the regulated area per work shift and a minimum of 32 square feet for all other projects.

Part 7 - Regulation of Work Area

Establish a regulated work area utilizing "Asbestos Warning" barrier tape and *OSHA* warning signs in accordance with *OSHA* 29 CFR 1910.1001 (j)(3) and *OSHA* 29 CFR 1926.1101 (k)(7).

The ME DEP work area shall be demarcated by barrier tape different than that of the *OSHA* posted area when they are not at the same limits of control.

The regulated work area for both *OSHA* & ME DEP shall extend as a minimum along the limits of the accessible negative pressure enclosure walls.

Part 8 - Asbestos Abatement

After erecting a functioning decontamination facility and properly isolating the work area by the establishment of a regulated barrier area, *OSHA* warning signs, and installation of drop cloths, proceed to remove asbestos containing materials identified herein and on the

attached drawings.

All impacted asbestos containing materials must be wetted with water containing a wetting agent.

The asbestos materials must be removed in such a manner as to prevent any visible airborne emissions in accordance with the National Emissions Standard for Hazardous Air Pollutants (*NESHAP*).

Once removed the asbestos containing materials must be maintained adequately wetted to prevent generation of dust until it is containerized.

The asbestos waste shall be contained in fiber tight containers and properly labeled as per *OSHA 29 CFR Part 1926.1101*.

Specific procedures by operations are as follows:

Glove Bag Removals

Glove bags cannot be set up on piping systems that have a surface temperature greater than 150⁰ F.

Set-up glove bag around the asbestos containing pipe insulation requested to be removed utilizing duct tape.

After installation is completed the glove bag integrity must be verified by a smoke test.

Smoke testing is the responsibility of the contractor and is required to be documented in the contractor's site logs.

In addition, polyethylene drop cloths must be setup under the glove bag removal areas.

After proper installation of the glove bags for completely enclosing the asbestos pipe insulation materials requiring removal, proceed to wet down and remove the insulation materials to provide an asbestos-free pipe length.

Visual Evaluation only is required for release of the area(s).

Part 9 - Waste Disposal

All asbestos waste shall be properly wetted prior to packaging.

Asbestos-containing materials shall be placed in double, individually sealed, pre-labeled 6-mil polyethylene bags or wrapped and sealed in two (2) independent layers of 6-mil polyethylene sheeting and properly labeled. Polyethylene wrapped packages shall have all

appropriate labeling attached to the exterior of said packages by use of self-adhering labels.

Prior to bagging any waste in polyethylene disposal bags that have the potential to puncture the bag, the waste shall first be placed into a woven or reinforced bag to prevent such puncturing of the disposal bags.

Prior to wrapping any waste in polyethylene sheeting that have sharp corners or other surfaces that have the potential to puncture the packaging shall be protected by duct tape or some other method to prevent penetration of the packaging.

Disposal bags and wrapped packages shall be labeled in accordance with all applicable requirements of:

<i>EPA</i> Regulations	40 CFR 61.152 (b) (iv)
<i>EPA</i> Regulations	40 CFR 763, Appendix D
<i>OSHA</i> Regulation	29 CFR 1910.1001
<i>OSHA</i> Regulation	29 CFR 1926.1101
<i>DOT</i> Regulation	49 CFR 172
<i>DOT</i> Regulation	49 CFR 173

Transportation and disposal of all containerized asbestos containing waste materials generated, as part of this activity, shall be the responsibility of the Abatement Contractor.

Asbestos-containing waste shall be properly disposed of at a ME DEP approved facility licensed to accept special waste.

The Abatement Contractor shall supply the Owner with copies of signed receipts from the permitted landfill operator clearly indicating the following:

- (a) Date
- (b) Time
- (c) Amount of material received
- (d) Authorized person's signature from permitted landfill
- (e) Name and address of transporter
- (f) Driver's signature
- (g) Name and address of permitted landfill operator
- (h) Date and Time material is to be land-filled.

These receipts are required to be received by the Client/Owner within 35 days of actual receipt of the material at the approved permitted landfill.

All bags or wraps of asbestos-containing waste shall also be labeled as follows:

Rice Public Library
Kittery, ME
"Date"
Abram Env.

All packaged waste shall be removed from any enclosure system or general work areas at the end of each workday and/or prior to final visual evaluations.

Part 10 - Respiratory Protection, Personal Protective Equipment, and Personal Monitoring

All personnel working in the regulated work areas for the removal of *non-friable* and *friable* asbestos materials shall wear as a minimum a Half-Face Negative Pressure Respirator equipped with dual P-100 (HEPA) cartridges, or better, as deemed appropriate by the Contractor's personal monitoring program.

All personnel, in addition to respiratory protection, shall wear disposable outer clothing, including head and foot cover.

Personal monitoring that may be conducted during removal and clean-up phases of this abatement project are the responsibility of the Abatement Contractor.

All monitoring shall be in accordance with the *OSHA Reference Method* as specified in *OSHA 29 CFR 1910.1001* and *OSHA 29 CFR 1926.1101*.

Part 11 - Worker Decontamination

All individuals must pass through the decontamination facility and properly decontaminate prior to exiting the regulated area. For remote decontamination ("blue suiting techniques"), all persons leaving the barriered area shall first don a clean suit over the "dirty" suit worn during activities in the posted work area.

Decontamination shall be achieved by removing all clothing and footwear except a bathing suit, if worn, in the Equipment Room. The individual will then enter the Shower Room and thoroughly rinse utilizing soap and water. Respirators must be worn into the Shower Room, and washed clean as part of the decontamination procedure.

Clothing or footwear used or worn in the regulated area must not leave the Equipment Room unless containerized for re-use inside a regulated area, cleaned, or disposed of. Clothing worn under protective suits and footwear must be designated for asbestos use only and be easily identifiable by sight by permanently marking or labeling (minimum 3/4 inch lettering) as "Asbestos Clothing" on the outside of the clothing or footwear.

Containerized clothing or footwear must be opened only inside a regulated area,

excluding the clean room.

Only impervious materials such as rubber, polyethylene, etc., may be cleaned in the decontamination facility and released for unrestricted use. Clothing and other pervious materials, such as leather boots, must be cleaned according to applicable OSHA requirements.

Part 12 - AIR MONITORING PROGRAM

John M. Boilard; ME DEP AM-0037

Air Monitoring is optional unless stipulated by contract or agreement with the Owner. Air clearance sampling of enclosure systems is always required. Generation of ME DEP Air Monitoring Disclosure Forms and signed copies onsite are required and is the responsibility of the Abatement Contractor to generate such documentation.

If Air Monitoring is performed, a licensed ME DEP Air Monitor must collect the samples and the following will occur:

Monitoring during Asbestos Abatement (Recommended – Not Required)

Regulated Work Areas

Area monitoring of airborne fiber levels (*if required by contract*) are to be performed, but not limited to, as follows:

Inside Regulated Work Area	2 per eight hour shift
Outside Regulated Work Area	2 per eight hour shift
Clean Room	1 per eight hour shift

Airborne sample collection & analysis will be performed utilizing NIOSH Method #7400 for Phase Contrast Microscopy (PCM), Issue 2, 15 August 1994.

If at any time the airborne fiber concentrations outside the containment during the removal of asbestos exceed 0.01 fibers per cubic centimeter (f/cc) **or** visible emissions are observed emanating from the work area during asbestos removal activities, a stop work order will be issued and all abatement activities shall cease until the source of the contamination is identified and resolved.

Visual inspection of the work areas (Mandatory)

The work area(s) shall not be released or air clearance sampled, as needed, until a licensed ME DEP Air Monitor, Independent of the contractor, completes a satisfactory visual evaluation.

The visual evaluation(s) by the ME DEP Air Monitor shall comply with *Maine DEP* CMR 425, Section 8, Part B(1).

Air Clearance Sampling (Non-mandatory)

Not applicable to this project.

Release of Work Area(s)

After the Independent ME DEP Air Monitor gives clearance, the Abatement Contractor will remove all postings and/or all containment polyethylene/drop cloths and dispose of it as contaminated waste.

The Abatement Contractor shall also remove all other tools, equipment, barrier tape, signs, and waste from the work site.

Immediately upon completion of removal of any containment system sheeting or drop cloths, a ME DEP Asbestos Air Monitor or ME DEP Asbestos Project Supervisor must visually inspect all surfaces within the regulated area for visible debris.

If visible debris is observed, the regulated area must be cleaned by HEPA vacuum or wet methods until there is no visible dust or debris present.

This final inspection must be documented in the daily project log. This documentation must include the following:

- a.) A statement that the regulated area was clear of visible debris and;
- b.) The name and signature of the person conducting this final inspection.

ABATMENT of ASBESTOS PIPE INSULATIONS
RICE PUBLIC LIBRARY; 8 WENTWORTH STREET; KITTERY, MAINE

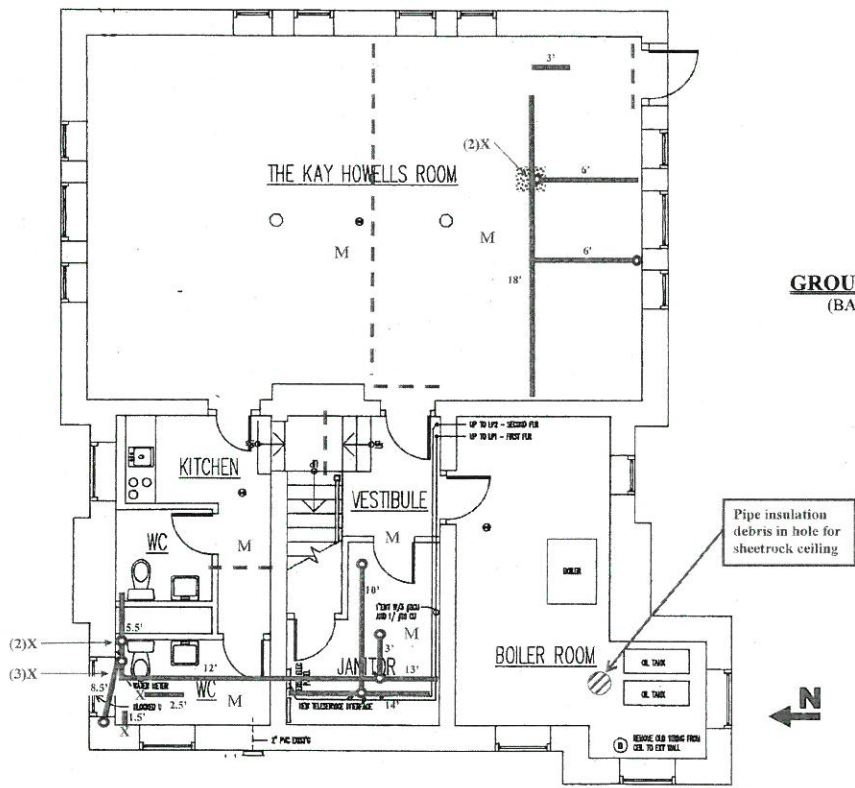

GROUND LEVEL
(BASEMENT)

KEY:	
	ASBESTOS PIPE INSULATION
	ASBESTOS RISER
	ASBESTOS FITTING
	PIPE FITTING DEBRIS on TOP of CEILING TILE
	REGULATED WORK AREA
	AIR MONITORING AIR SAMPLES

	NORTHEAST TEST CONSULTANTS
	NTC JOB #13287-2012
DRAWING NOT TO SCALE	DRAWING DATE: 10-2-2012 JMB

Asbestos Project Notification

State of Maine
 Department of Environmental Protection
 Lead & Asbestos Hazard Prevention Program
 17 State House Station, Augusta, ME 04333
 TEL (207) 287-2651 FAX (207) 287-6220

FORM N

Page 1 of 5
Revised 2011

Important Notice: The notification submitter must send a complete notification including all applicable fees, postmarked at least 10 calendar days or received by the Department at least 5 working days prior to the start of an asbestos abatement project. This notification must be typewritten or easily legible. An incomplete notification is not acceptable & therefore not of record. See definition of project at Asbestos Management Regulations, 06-096 CMR 425(1)(DDDD)(last amended April 3, 2011). **The notification submitter is responsible for ensuring that the complete notification including any applicable fee is received by the Department.**

COPY

1. Project Code NTC 13287 -2012 (Assigned by notification submitter)	2. Original Notification <input checked="" type="checkbox"/> Standard <input type="checkbox"/> Facility O&M (Approved Annual) <input type="checkbox"/> Courtesy (Not Subject to the Rule)	3. Type of Activity <input type="checkbox"/> Demolition <input checked="" type="checkbox"/> Renovation	4. Waiver <input type="checkbox"/> Non Standard Work Practices <input type="checkbox"/> Emergency <input type="checkbox"/> Notification Timeframe Waiver <input type="checkbox"/> Approved Annual Non Standard
---	---	---	---

5. Facility Owner Name RICE PUBLIC LIBRARY Address 8 WENTWORTH STREET City KITTERY State ME Zip 03904 Contact LEE PERKINS TEL (207) 439 - 1553 FAX n/a	6. Asbestos Contractor Name ABRAM ENVIRONMENTAL Address P.O. BOX 2038 City WINDHAM State ME Zip 04062 Contact COLIN BECKWITH TEL (207) 756-2252 FAX n/a
--	---

7. Facility Location (Where removal is to take place) BLDG Name RICE PUBLIC LIBRARY Floor and/or Rm.# Basement: Kay Howells Room, Bathrom, & Janitors Closet Physical Address 8 WENTWORTH STREET City KITTERY State ME Zip 03904	8. Facility Description Present Use PUBLIC LIBRARY Prior Use Same BLDG Size 2,800 Sq Ft No. Floors 4 BLDG Age 35+
---	--

9. Asbestos (ACM) Removal			
ACM Type	Amount	Measurement	Project Totals
Pipe or Pipe Covering	102	Linear Feet	Total Square Feet = 0
Boiler Covering		Square Feet	
Mudded Fittings		Linear Feet	Total Linear Feet = 102
Duct Covering		Square Feet	
Gasket Material		Square Feet	Total Project = 102
Floor Tile		Square Feet	
Linoleum		Square Feet	
Mastic		Square Feet	
Ceiling Tiles		Square Feet	
Spray-on		Square Feet	
Siding		Square Feet	
Transite Paneling		Square Feet	
Roofing/Flashing		Square Feet	
Glues		Square Feet	

Note: Visual evaluations and air clearances for asbestos abatement projects involving more than 100 square/linear feet, or any combination thereof of must be performed by an independent Asbestos Consultant unless otherwise specified in Asbestos Management Regulations, 06-096 CMR 425) (effective April 3, 2011).

Asbestos Project Notification

NTC 13287-2012
Project Code

State of Maine
Department of Environmental Protection
Lead & Asbestos Hazard Prevention Program
17 State House Station, Augusta, ME 04333
TEL (207) 287-2651 FAX (207) 287-6220

FORM N

Page 2 of 5
Revised 2011

10. Notification Fees (Required fees must accompany notification)

- \$100.00 = ACM amounts 100 Sq Ft or 100 Ln Ft or any combination but less than 500 Sq Ft or 2500 Ln Ft.
- \$150.00 = ACM amounts more than 500 Sq Ft or 2500 Ln Ft but less than 1000 Sq Ft or 5000 Ln Ft.
- \$300.00 = ACM amounts more than 1000 Sq Ft or 5000 Ln Ft or any combination

11. Notification Fee Not Included

- Single family home exemption
- ACM amount less than 100 Sq Ft or 100 Ln Ft or any combination
- Fees paid quarterly (Non-Scheduled O&M only)
- BGS exemption
- Fee to follow within 3 days (Emergency/Notification Waiver only)

12. Demolition (complete as applicable)

- Ordered demolition (structurally unsound) by State or local government
- All other demolitions

Demolition Dates:

Start
End

Note on Required Notification Fees

If there are not sufficient funds to cover the check or credit card transaction an insufficient funds fee will be assessed by the Department in accordance with State of Maine laws and policies. Until that insufficiency is resolved (by money order or bank check), the Department will not accept any additional checks or credit card transactions from the party including additional checks for other project notifications.

13. Scheduled Dates for Asbestos Project

Project Start Date 10 / 15 / 2012 & 10 / 22 / 2012

Project Completion Date 10 / 15 / 2012 & 10 / 22 / 2012

ACM Removal Dates (from) 10 / 15 / 2012 & 10 / 22 / 2012

ACM Removal Dates (to) 10 / 15 / 2012 & 10 / 22 / 2012

14. Project Work Hours

8:00 AM to 5:00 PM (Show actual hours)

Weekdays (Check all that apply)

M T W T F

Weekend (Check all that apply)

Sat Sun

15. Procedure Used to Detect Presence of Asbestos

Testing Assumed Positive Tested Positive

Method PLM TEM

Sampled By Brain Cohen, ME DEP #AI-557
(Print Name)

Company Northeast Test Consultants

16. Project Clearance

Visual evaluation by: (Air Monitor (if known) and Company)

NTC

Air Clearance by: (Air Monitor (if known) and Company)

n/a

Note: Whenever building materials are assumed to contain asbestos, signed bulk sampling disclosure forms must be at the asbestos abatement project site and available for review by the Department.

17. Asbestos Abatement Design Consultant of Record

Name John M. Boilard Me Certification Number DC- 0260

Company Northeast Test Consultants DC Certification Expiration Date 11 - 30 - 2012

Asbestos Project Notification

NTC 13287-2012
Project Code

State of Maine
Department of Environmental Protection
Lead & Asbestos Hazard Prevention Program
17 State House Station, Augusta, ME 04333
TEL (207) 287-2651 FAX (207) 287-6220

FORM N

Page 3 of 5
Revised 2011

18. Asbestos Abatement Methods and Alternative Work Practices (check all that apply)

- | | |
|---|---|
| <input type="checkbox"/> Regulated area with containment consisting of 2-layers 4 mil poly on walls & ceiling & 2 layers 6 mil poly on floors | <input type="checkbox"/> Wetting ACM during removal not required |
| <input type="checkbox"/> Regulated area with containment consisting of 1-layer 6 mil poly on walls & ceiling & 2 layers 6 mil poly on floors | <input type="checkbox"/> Exhausting to Ambient Air not feasible |
| <input checked="" type="checkbox"/> Regulated area with Exclusion zone | <input type="checkbox"/> Aggressive Air Clearance not required |
| <input checked="" type="checkbox"/> Glovebags (unlimited non-contiguous, contiguous limited to 30 In ft) | <input checked="" type="checkbox"/> Visual Clearance only |
| <input type="checkbox"/> Adhesive by grinding or bead blasting | <input checked="" type="checkbox"/> Remote Decontamination Unit |
| <input type="checkbox"/> Wrap & cut- TSI in good condition (no containment) | <input type="checkbox"/> Smaller than standard Decontamination Unit |
| <input type="checkbox"/> Intact flooring demo by heavy equipment | <input type="checkbox"/> Shutting down NAM at night |
| <input type="checkbox"/> Roofing removal by mechanical saws/cutters | <input type="checkbox"/> Encapsulation |
| <input type="checkbox"/> Flooring by mechanical equipment/ice scrapers/pry bars | |
| <input type="checkbox"/> Enclosure | |

Note on AHERA School Projects

The Federal Asbestos – Containing Materials in Schools regulation (40 CFR Part 763) commonly referred to as “AHERA” contains specific requirements for asbestos abatement activities that may not be waived by the Department. Among these are air clearance and sample analysis protocols.

19. Waste Transporter (Must be ME DEP licensed Non-Hazardous Waste Transporter)

Name WASTE MANAGEMENT OF MAINE, INC.
Address 2000 FOREST AVENUE
City PORTLAND State ME Zip 04104 - 0957
Contact MIKE O'BRIEN
TEL (207) 797 - 8290 FAX

20. Disposal Site

Name WASTE MANAGEMENT of MAINE, INC.
Address P.O. BOX 629 ; ROUTE 2
City NORRIDGEWOCK State ME Zip 04957
Contact JEFFERY MCGOWN
TEL 800 - 562 - 7779 FAX (207) 634 - 4519

21. Certification (Notification Submitted by)

I certify that to the best of my knowledge, the information contained in this notification is true and accurate, and that the asbestos abatement contractor will be/has been contracted to implement work practices as required by 06-096 CMR 425 effective April 3, 2011.

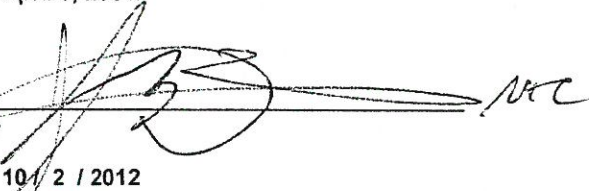
Signature 
Date 10/2/2012

John M. Boilard
Print Name

Mailing Address NORTHEAST TEST CONSULTANTS; 587 SPRING STREET
City Westbrook State ME Zip 04092
TEL 854-3939 FAX 854-3658

Remember

Submit completed pages 1 thru 3 of Form N for each original notification.

Submit pages 4 or 5 only as needed.

ME DEP USE ONLY

Postmark/ FAX/ hand-delivered _____
Date Received _____ Check # _____
NESHAP _____ State _____
Waiver _____