



# Town of Kittery

## York County, Maine

### Land Use Zoning Map

(A Growth Management / Comprehensive Plan Implementation Strategy)

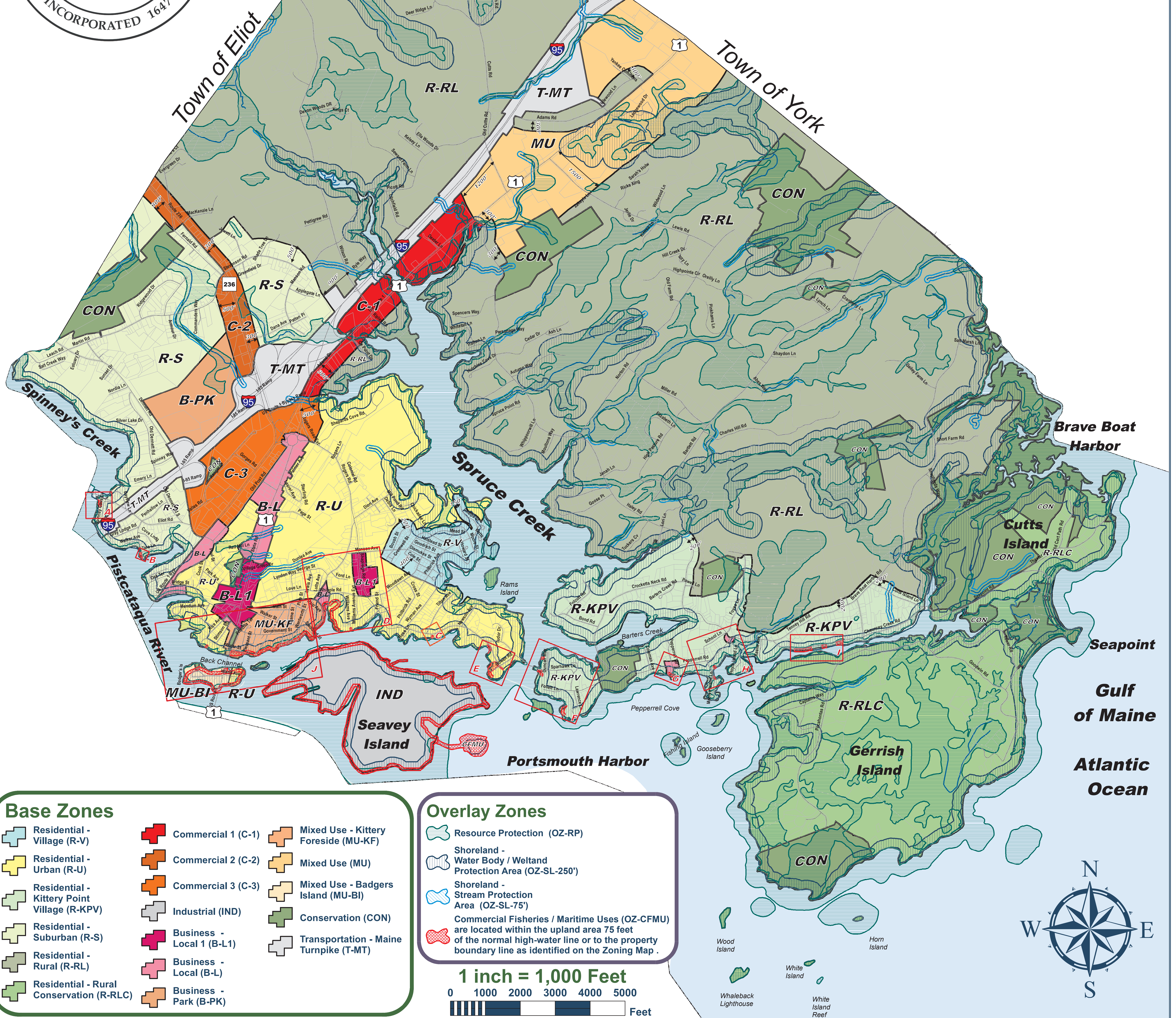

#### Base Zones

- |   |                           |  |
|---|---------------------------|--|
| Residential - Village (R-V)                 | Commercial 1 (C-1)        | Mixed Use - Kittery Foreside (MU-KF)   |
| Residential - Urban (R-U)                   | Commercial 2 (C-2)        | Mixed Use (MU)                         |
| Residential - Kittery Point Village (R-KPV) | Commercial 3 (C-3)        | Mixed Use - Badgers Island (MU-BI)     |
| Residential - Suburban (R-S)                | Industrial (IND)          | Conservation (CON)                     |
| Residential - Rural (R-RL)                  | Business - Local 1 (B-L1) | Transportation - Maine Turnpike (T-MT) |
| Residential - Rural Conservation (R-RLC)    | Business - Local (B-L)    |  |
|   | Business - Park (B-PK)    |  |

#### Overlay Zones

- Resource Protection (OZ-RP)
- Shoreland - Water Body / Wetland Protection Area (OZ-SL-250')
- Shoreland - Stream Protection Area (OZ-SL-75')
- Commercial Fisheries / Maritime Uses (OZ-CF) are located within the upland area 75 feet of the normal high-water line or to the property boundary line as identified on the Zoning Map.

1 inch = 1,000 Feet

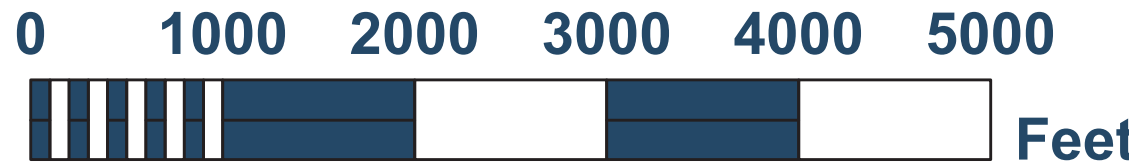

**Inset A**

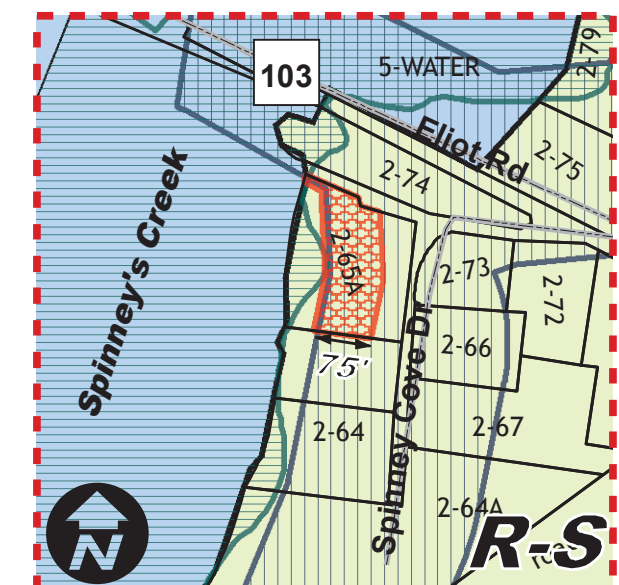

**Inset B**

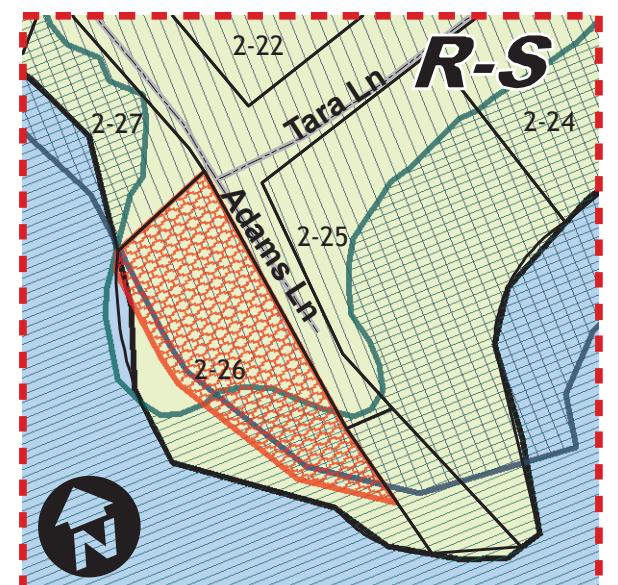

**Inset C**



**Inset D**

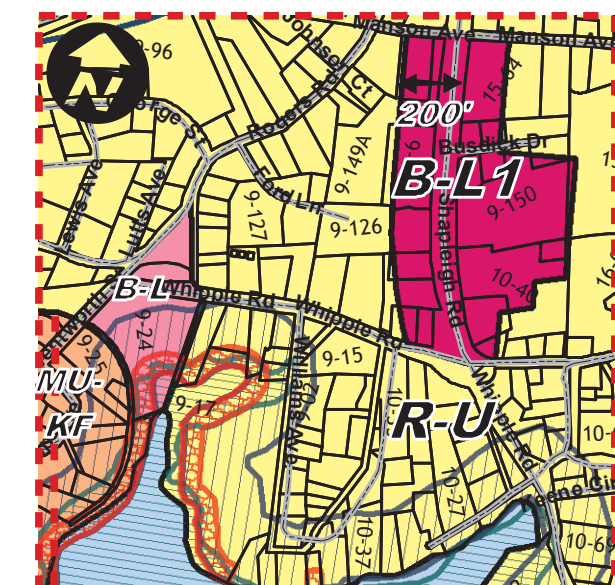

**Inset E**

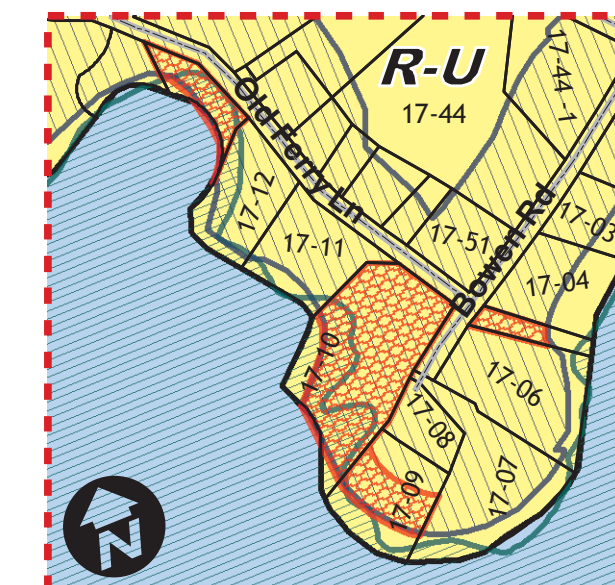

**Inset F**



**Inset G**

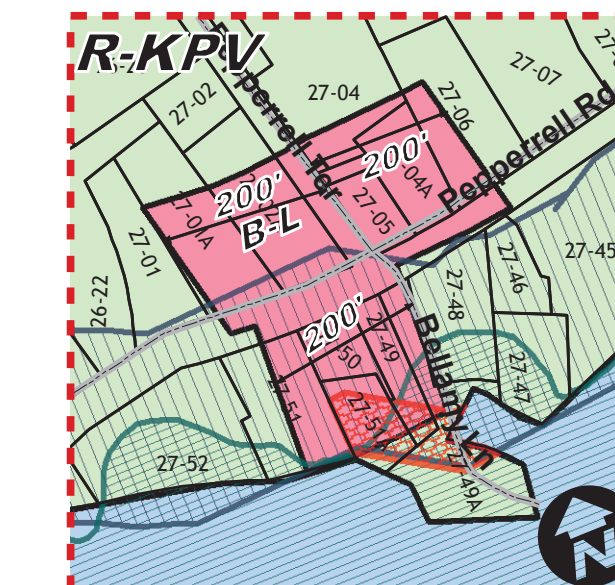

**Inset H**

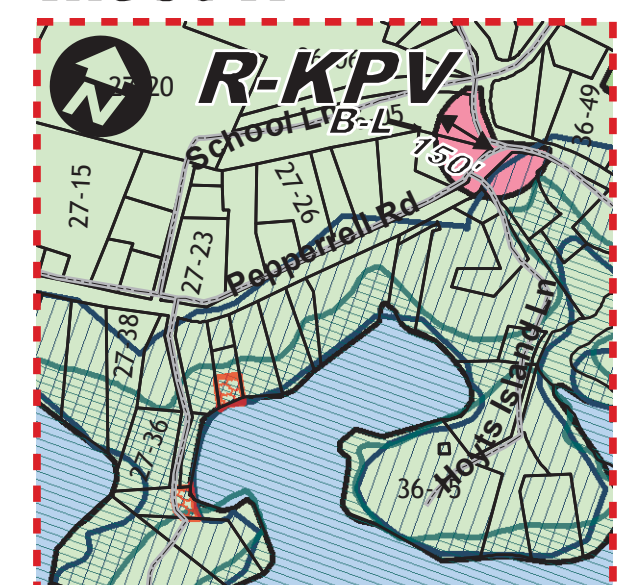

**Inset I**

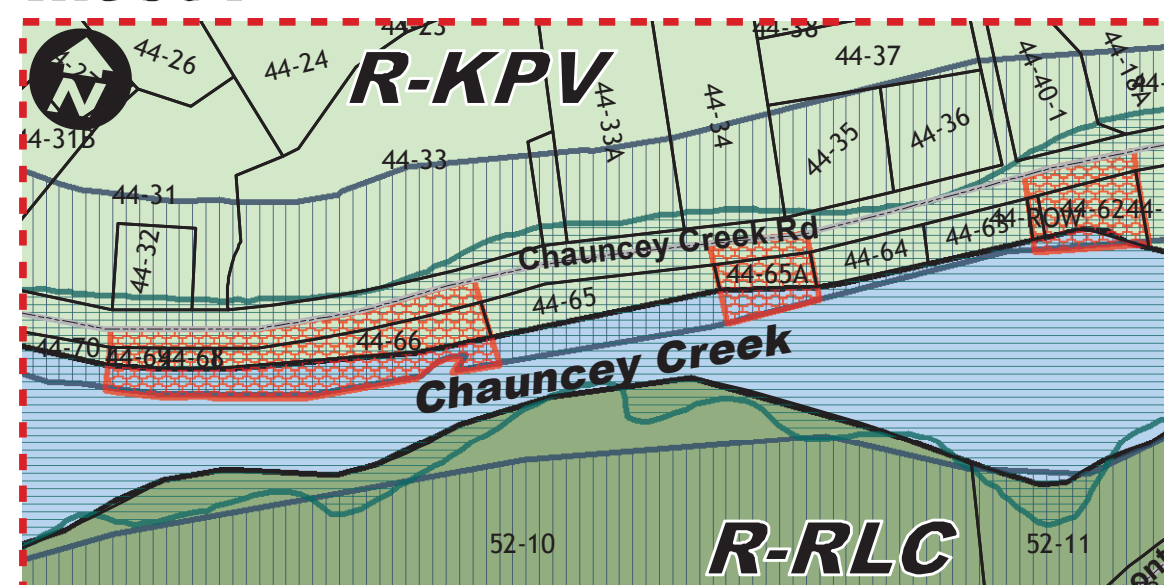

**Inset J**

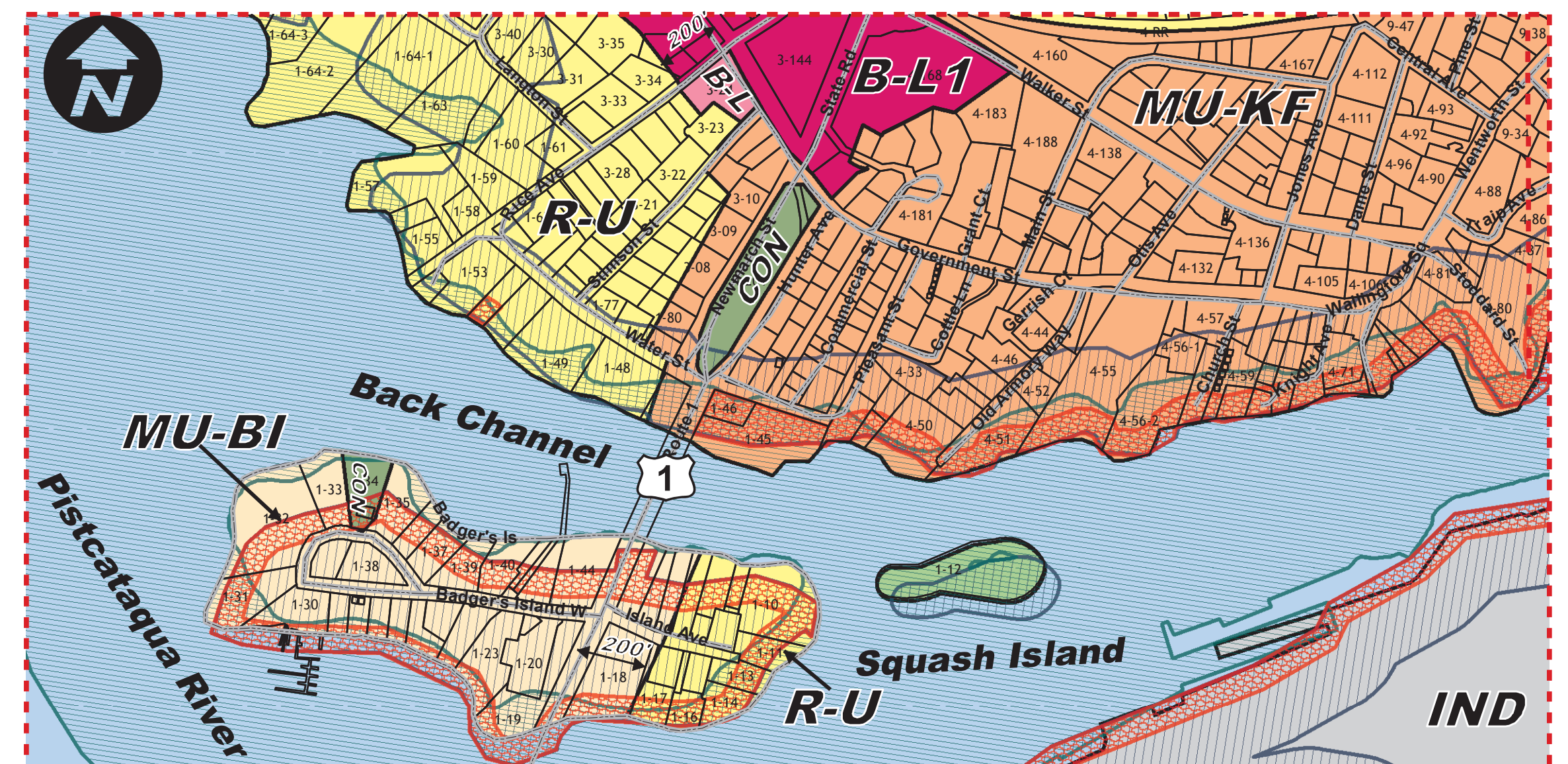

I hereby certify this Zoning Map, referred to in the Town Land Use and Development Code, is the Official Zoning Map for the Town of Kittery, Maine. It includes all prior revisions and is current as of this date.

The precise location of property, boundary lines, and natural resources as shown on this Official Zoning Map is not warranted. Where there exists any doubt in the accuracy of any such property, boundary lines, or natural resources, the property owner is responsible to demonstrate the exact lot line or natural resource locations with respect to the zone boundaries. Such accuracy may be established through a licensed survey or appropriate state certified professional consistent with the Town Code.

Adopted by the Kittery Town Council and Effective this May 24, 2010.

Maryann Place 5/24/10

Maryann Place, Town Clerk

Map prepared by the  
Kittery Planning & Development Department  
Michael Ascioia